

NOTE: REFER TO
 DOOR HEAD: SSAS3IU061
 DOOR JAMB: SSAS3IU071

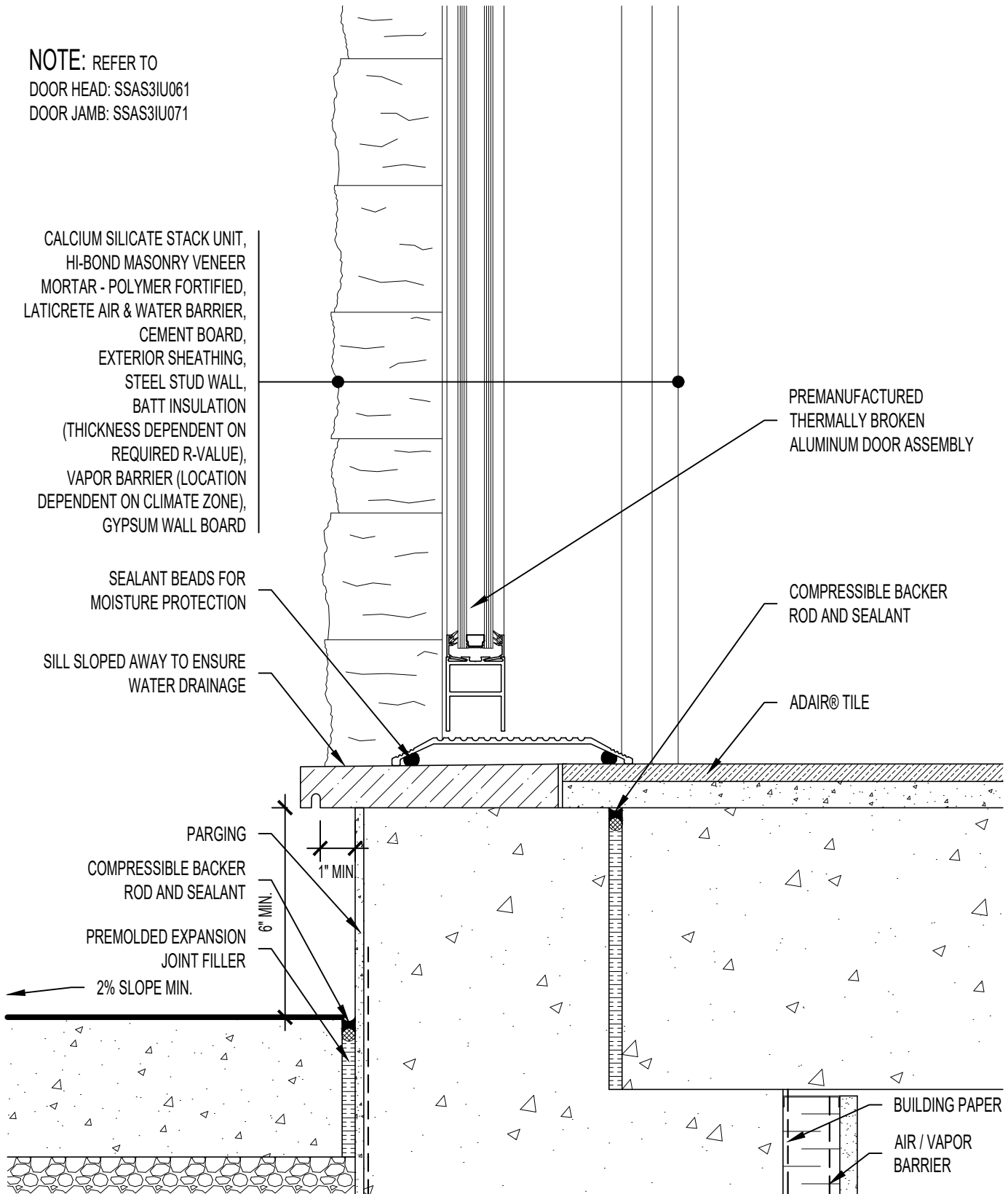

CALCIUM SILICATE STACK UNIT,
 HI-BOND MASONRY VENEER
 MORTAR - POLYMER FORTIFIED,
 LATICRETE AIR & WATER BARRIER,
 CEMENT BOARD,
 EXTERIOR SHEATHING,
 STEEL STUD WALL,
 BATT INSULATION
 (THICKNESS DEPENDENT ON
 REQUIRED R-VALUE),
 VAPOR BARRIER (LOCATION
 DEPENDENT ON CLIMATE ZONE),
 GYPSUM WALL BOARD

PREMANUFACTURED
 THERMALLY BROKEN
 ALUMINUM DOOR ASSEMBLY

SEALANT BEADS FOR
 MOISTURE PROTECTION

COMPRESSIBLE BACKER
 ROD AND SEALANT

SILL SLOPED AWAY TO ENSURE
 WATER DRAINAGE

ADAIR® TILE

PARGING
 COMPRESSIBLE BACKER
 ROD AND SEALANT

PREMOLDED EXPANSION
 JOINT FILLER

2% SLOPE MIN.

BUILDING PAPER
 AIR / VAPOR
 BARRIER



ARRISCRAFT-CADD

DETAIL No:
 SSAS3I

TITLE:
 THRESHOLD OF DOOR

U050

DATE DRAWN:
 13 Jan 2021

SCALE:
 3"=1'-0"

DRAWN BY:
 TRI