

**ARCHITECT NOTE:**

- DETAIL FOR UNSUPPORTED PROGUARD DP® - DOUBLE DRAINAGE PLANE PANELS.
- ENGINEER OF RECORD TO SELECT PROGUARD DP® SCREW SPACING USING NTA REPORT TRIG030116-28.

THIN-CLAD CALCIUM SILICATE TILE,  
 MVIS™ HI-BOND VENEER MORTAR -  
 POLYMER FORTIFIED,  
 PROGUARD DP® INSULATED CONCRETE  
 BOARD PANEL - DOUBLE DRAINAGE  
 PLANE (THICKNESS DEPENDENT ON  
 REQUIRED R-VALUE),  
 MVIS™ AIR & WATER BARRIER or  
 WATERARMOR® AWB,  
 EXTERIOR SHEATHING,  
 STEEL STUD WALL,  
 VAPOR BARRIER (LOCATION  
 DEPENDENT ON CLIMATE ZONE),  
 GYPSUM WALLBOARD

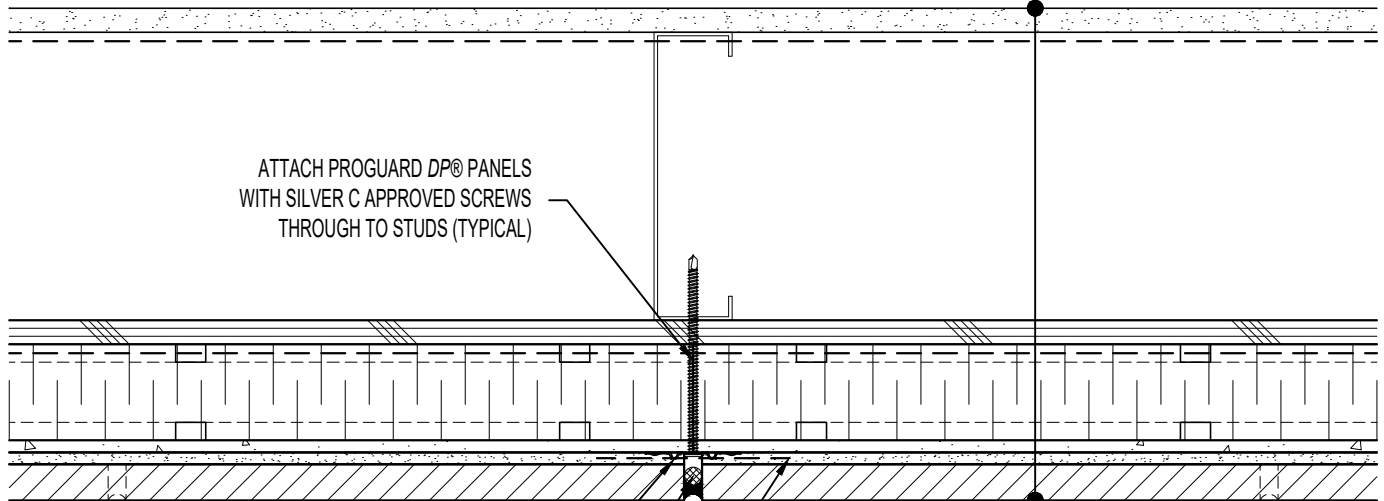

ATTACH PROGUARD DP® PANELS  
 WITH SILVER C APPROVED SCREWS  
 THROUGH TO STUDS (TYPICAL)

2" SILVER C NON-BARB PLATE WASHERS -  
 GALVANIZED USED w/ SILVER C APPROVED  
 SCREWS AT ALL VERTICAL PANEL JOINTS

MOVEMENT JOINT SEALED WITH  
 SILICONE SEALANT AND BACKER ROD

TAPE JOINT WITH ALKALI-RESISTANT  
 MESH TAPE AND MUD JOINT WITH  
 MVIS™ HI-BOND VENEER MORTAR

3/8" MIN.



**ARRISCRAFT-CADD**

TITLE: PROGUARD DP® - DOUBLE  
 DRAINAGE PLANE EXPANSION  
 JOINT DETAIL (PLAN VIEW)

DETAIL No:

SS08SAT - DP2U

**U141**

DATE DRAWN:  
 16 Jan 2021

SCALE:  
 3"=1'-0"

DRAWN BY:  
 TRI