

NOTE: REFER TO

DOOR THRESHOLD: SS08SAT-DP2UU052

DOOR JAMB: SS08SAT-DP2UU072

MVIS™ POINTING MORTAR

THIN-CLAD CALCIUM SILICATE TILE,
MVIS™ HI-BOND VENEER
MORTAR - POLYMER FORTIFIED,
PROGUARD DP® INSULATED CONCRETE
BOARD PANEL - DOUBLE DRAINAGE
PLANE (THICKNESS DEPENDENT ON
REQUIRED R-VALUE),
MVIS™ AIR & WATER BARRIER or
WATERARMOR® AWB,
EXTERIOR SHEATHING,
STEEL STUD WALL,
VAPOR BARRIER (LOCATION
DEPENDENT ON CLIMATE ZONE),
GYPSUM WALLBOARD

ATTACH PROGUARD DP® PANELS
WITH SILVER C APPROVED SCREWS
THROUGH TO STUDS (TYPICAL)

1/4" CONCRETE BOARD MECHANICALLY
ATTACHED TO 16 GAUGE SUPPORT

COMPRESSIBLE BACKER ROD
AND SILICONE SEALANT

SILICONE COMPATIBLE
WEEP VENTS @ 24" o.c.

16 GAUGE MIN. (G90 COATED)
SUPPORT ANGLE

WATERPROOFING
TRANSITION MATERIAL

COMPRESSIBLE BACKER ROD AND
SILICONE SEALANT AROUND FRAME

SPRAY APPLIED FOAM INSULATING
AIR SEAL AROUND FRAME

PREMANUFACTURED
THERMALLY BROKEN ALUMINUM
WINDOW ASSEMBLY

ARCHITECT NOTE:

- DETAIL FOR UNSUPPORTED PROGUARD DP® - DOUBLE DRAINAGE PLANE PANELS.
- ENGINEER OF RECORD TO SELECT PROGUARD DP® SCREW SPACING USING NTA REPORT TRIG030116-28.

FLASHING MEMBRANE
ADHERED MIN. 4" UP
SUBSTRATE. OVERLAP
AIR / WATER BARRIER
OVER FLASHING

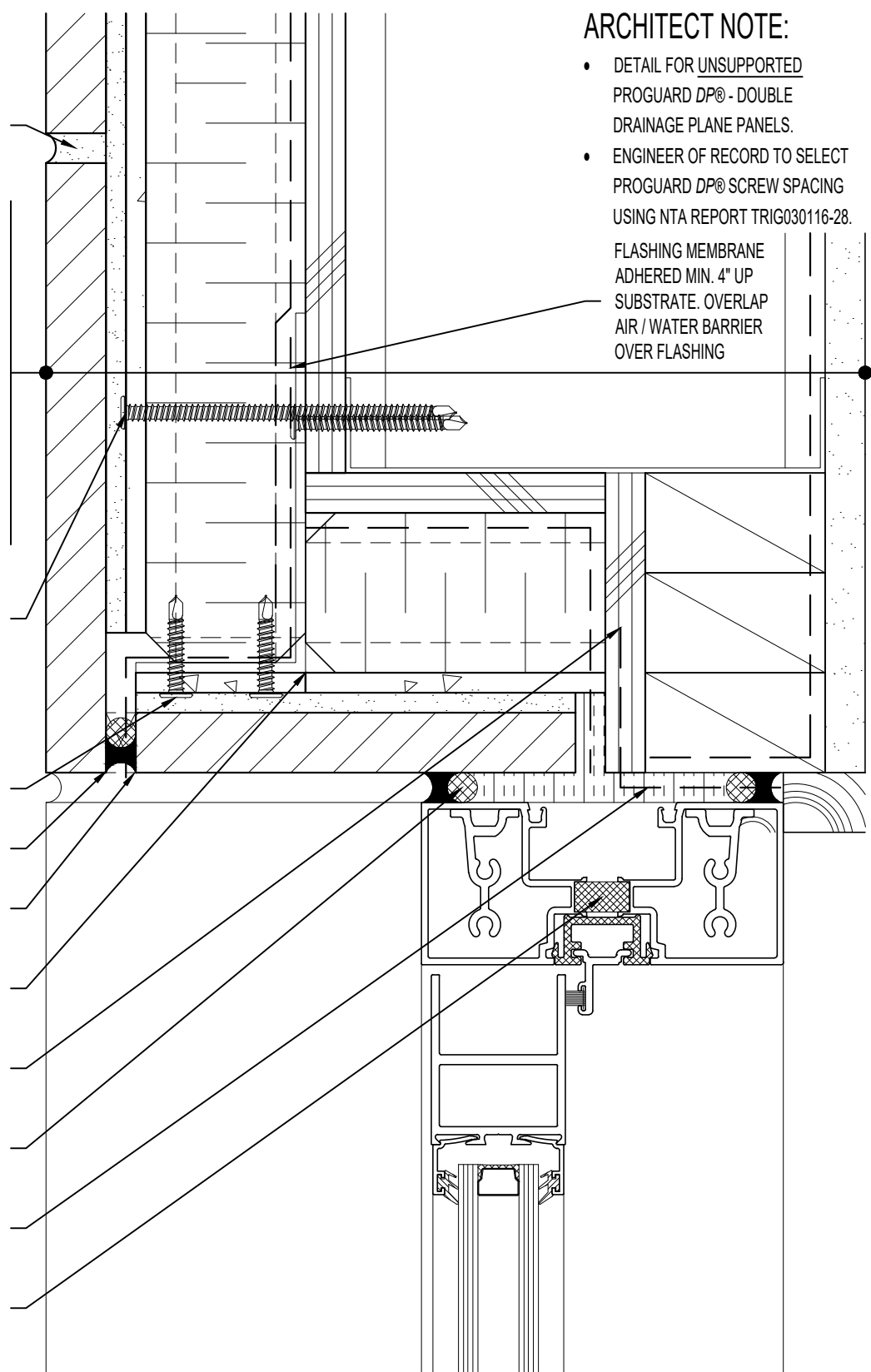

ARRISCRAFT-CADD

DETAIL No:

SS08SAT - DP2U

TITLE:

ALUMINUM DOOR HEAD -
DEEP RECESSED DOOR

U062

DATE DRAWN:

16 Jan 2021

SCALE:

1-1/2"=1'-0"

DRAWN BY:

TRI