

**NOTE:** REFER TO

WINDOW SILL: SS08SAT-DP2UU020  
 WINDOW HEAD: SS08SAT-DP2UU030

**ARCHITECT NOTE:**

- DETAIL FOR UNSUPPORTED PROGUARD DP® - DOUBLE DRAINAGE PLANE PANELS.
- ENGINEER OF RECORD TO SELECT PROGUARD DP® SCREW SPACING USING NTA REPORT TRIG030116-28.

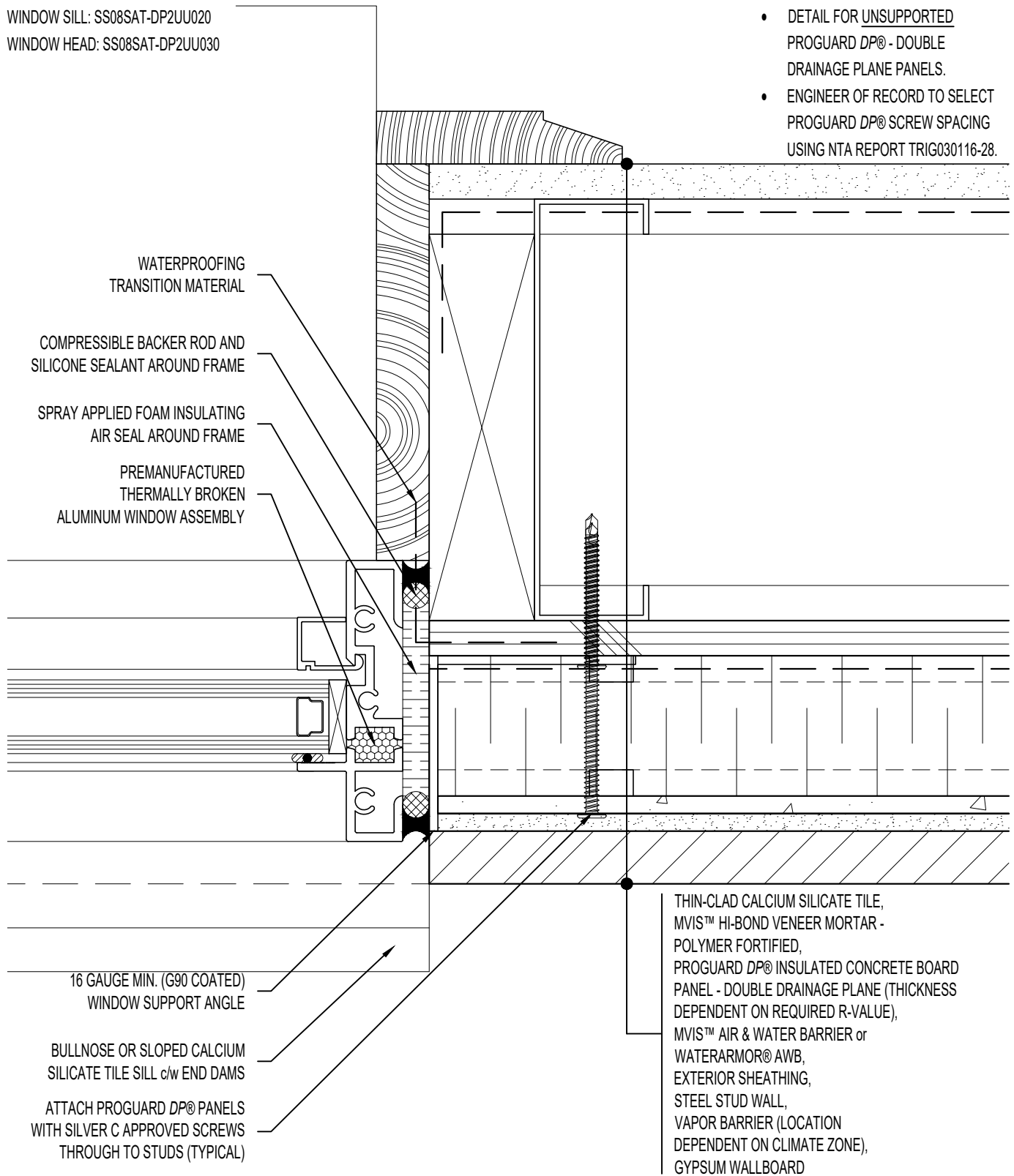

WATERPROOFING  
TRANSITION MATERIAL

COMPRESSIBLE BACKER ROD AND  
SILICONE SEALANT AROUND FRAME

SPRAY APPLIED FOAM INSULATING  
AIR SEAL AROUND FRAME

PREMANUFACTURED  
THERMALLY BROKEN  
ALUMINUM WINDOW ASSEMBLY

16 GAUGE MIN. (G90 COATED)  
WINDOW SUPPORT ANGLE

BULLNOSE OR SLOPED CALCIUM  
SILICATE TILE SILL c/w END DAMS

ATTACH PROGUARD DP® PANELS  
WITH SILVER C APPROVED SCREWS  
THROUGH TO STUDS (TYPICAL)

THIN-CLAD CALCIUM SILICATE TILE,  
MVIS™ HI-BOND VENEER MORTAR -  
POLYMER FORTIFIED,  
PROGUARD DP® INSULATED CONCRETE BOARD  
PANEL - DOUBLE DRAINAGE PLANE (THICKNESS  
DEPENDENT ON REQUIRED R-VALUE),  
MVIS™ AIR & WATER BARRIER or  
WATERARMOR® AWB,  
EXTERIOR SHEATHING,  
STEEL STUD WALL,  
VAPOR BARRIER (LOCATION  
DEPENDENT ON CLIMATE ZONE),  
GYPSUM WALLBOARD



**ARRISCRAFT-CADD**

DETAIL No:  
SS08SAT - DP2U

TITLE:  
WINDOW JAMB WITH  
TILE SILL (PLAN VIEW)

**U041**

DATE DRAWN: 16 Jan 2021	SCALE: 1-1/2"=1'-0"	DRAWN BY: TRI
----------------------------	------------------------	------------------