

NOTE: REFER TO

WINDOW HEAD: SS08SAT-DP2UU030
 WINDOW JAMB: SS08SAT-DP2UU041

ARCHITECT NOTE:

- DETAIL FOR UNSUPPORTED PROGUARD DP® - DOUBLE DRAINAGE PLANE PANELS.
- ENGINEER OF RECORD TO SELECT PROGUARD DP® SCREW SPACING USING NTA REPORT TRIG030116-28.

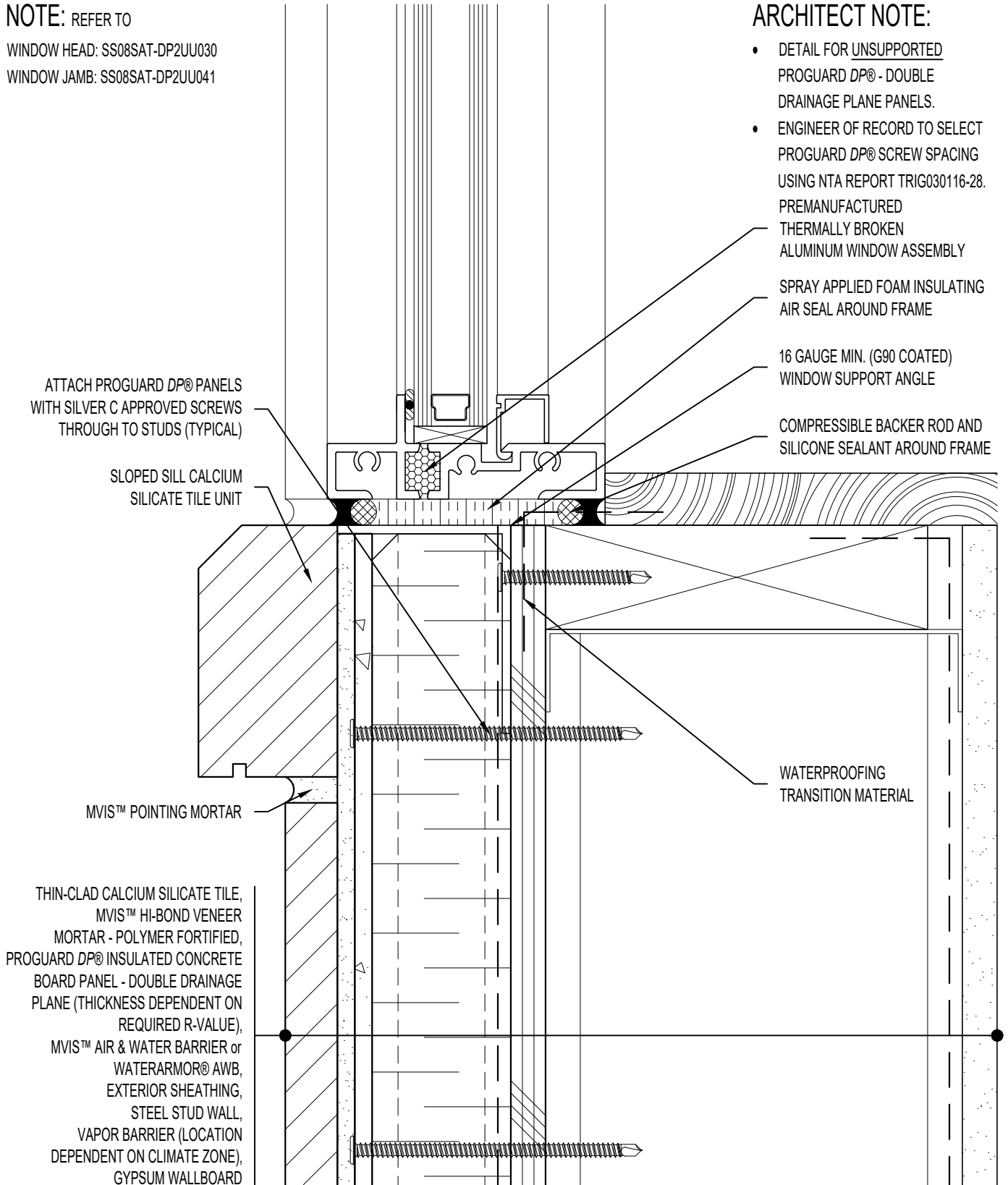

ATTACH PROGUARD DP® PANELS WITH SILVER C APPROVED SCREWS THROUGH TO STUDS (TYPICAL)

SLOPED SILL CALCIUM SILICATE TILE UNIT

MVIS™ POINTING MORTAR

THIN-CLAD CALCIUM SILICATE TILE, MVIS™ HI-BOND VENEER
 MORTAR - POLYMER FORTIFIED,
 PROGUARD DP® INSULATED CONCRETE BOARD PANEL - DOUBLE DRAINAGE PLANE (THICKNESS DEPENDENT ON REQUIRED R-VALUE),
 MVIS™ AIR & WATER BARRIER or WATERARMOR® AWB,
 EXTERIOR SHEATHING,
 STEEL STUD WALL,
 VAPOR BARRIER (LOCATION DEPENDENT ON CLIMATE ZONE),
 GYPSUM WALLBOARD

SPRAY APPLIED FOAM INSULATING AIR SEAL AROUND FRAME

16 GAUGE MIN. (G90 COATED) WINDOW SUPPORT ANGLE

COMPRESSIBLE BACKER ROD AND SILICONE SEALANT AROUND FRAME

WATERPROOFING TRANSITION MATERIAL



ARRISCRAFT-CADD

TITLE:

SLOPED WINDOW SILL

DETAIL No:

SS08SAT - DP2U

U022

DATE DRAWN:

16 Jan 2021

SCALE:

1-1/2"=1'-0"

DRAWN BY:

TRI