

NOTE: REFER TO

WINDOW HEAD: SS08SAT-DP2UU030
 WINDOW JAMB: SS08SAT-DP2UU040

ARCHITECT NOTE:

- DETAIL FOR UNSUPPORTED PROGUARD DP® - DOUBLE DRAINAGE PLANE PANELS.
 - ENGINEER OF RECORD TO SELECT PROGUARD DP® SCREW SPACING USING NTA REPORT TRIG030116-28.
- PREMANUFACTURED THERMALLY BROKEN ALUMINUM WINDOW ASSEMBLY
- SPRAY APPLIED FOAM INSULATING AIR SEAL AROUND FRAME
- 16 GAUGE MIN. (G90 COATED) WINDOW SUPPORT ANGLE
- COMPRESSIBLE BACKER ROD AND SILICONE SEALANT AROUND FRAME

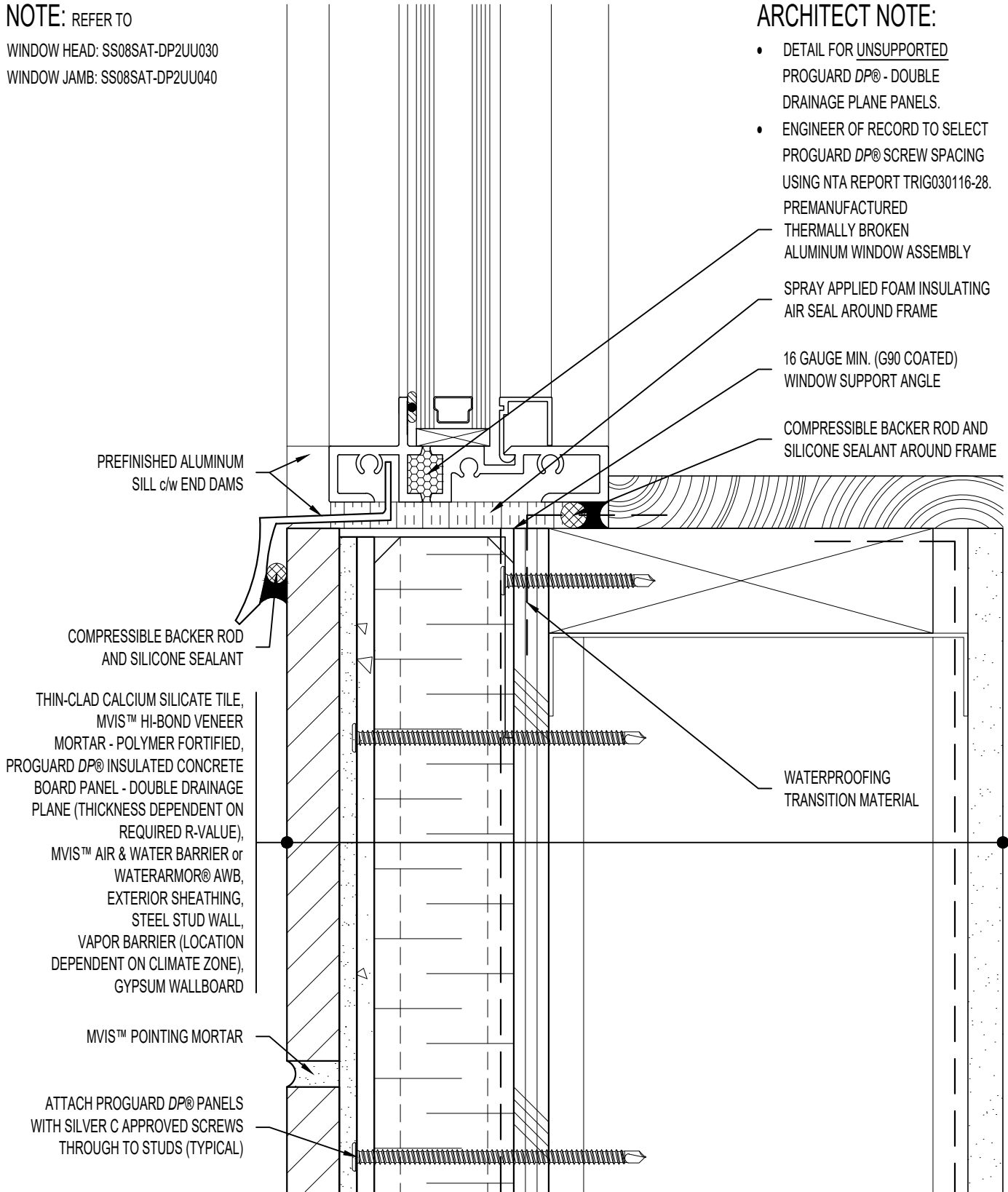

PREFINISHED ALUMINUM SILL c/w END DAMS

COMPRESSIBLE BACKER ROD AND SILICONE SEALANT

THIN-CLAD CALCIUM SILICATE TILE, MVIS™ HI-BOND VENEER MORTAR - POLYMER FORTIFIED, PROGUARD DP® INSULATED CONCRETE BOARD PANEL - DOUBLE DRAINAGE PLANE (THICKNESS DEPENDENT ON REQUIRED R-VALUE), MVIS™ AIR & WATER BARRIER or WATERARMOR® AWB, EXTERIOR SHEATHING, STEEL STUD WALL, VAPOR BARRIER (LOCATION DEPENDENT ON CLIMATE ZONE), GYPSUM WALLBOARD

MVIS™ POINTING MORTAR

ATTACH PROGUARD DP® PANELS WITH SILVER C APPROVED SCREWS THROUGH TO STUDS (TYPICAL)

WATERPROOFING TRANSITION MATERIAL



ARRISCRAFT-CADD

TITLE:

ALUMINUM WINDOW SILL

DETAIL No:

SS08SAT - DP2U

U020

DATE DRAWN:

16 Jan 2021

SCALE:

1-1/2"=1'-0"

DRAWN BY:

TRI