

ARCHITECT NOTE:

- DETAIL FOR SUPPORTED PROGUARD DP® - DOUBLE DRAINAGE PLANE PANELS.
- ENGINEER OF RECORD TO SELECT PROGUARD DP® SCREW SPACING USING NTA REPORT TRIG030116-28.

THIN-CLAD CALCIUM SILICATE TILE,
 MVIS™ HI-BOND VENEER MORTAR -
 POLYMER FORTIFIED,
 PROGUARD DP® INSULATED CONCRETE
 BOARD PANEL - DOUBLE DRAINAGE
 PLANE (THICKNESS DEPENDENT ON
 REQUIRED R-VALUE),
 MVIS™ AIR & WATER BARRIER or
 WATERARMOR® AWB,
 EXTERIOR SHEATHING,
 STEEL STUD WALL,
 VAPOR BARRIER (LOCATION
 DEPENDENT ON CLIMATE ZONE),
 GYPSUM WALLBOARD

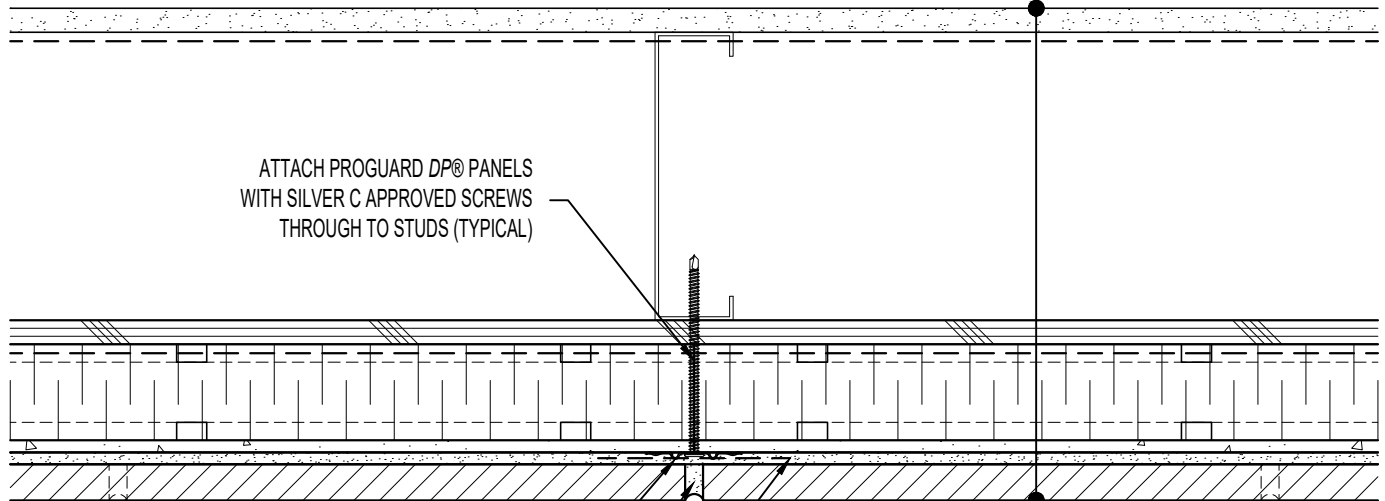

ATTACH PROGUARD DP® PANELS
 WITH SILVER C APPROVED SCREWS
 THROUGH TO STUDS (TYPICAL)

2" SILVER C NON-BARB PLATE WASHERS -
 GALVANIZED USED w/ SILVER C APPROVED
 SCREWS AT ALL VERTICAL PANEL JOINTS
 MVIS™ POINTING MORTAR

TAPE JOINT WITH ALKALI-RESISTANT
 MESH TAPE AND MUD JOINT WITH
 MVIS™ HI-BOND VENEER MORTAR



ARRISCRAFT · CADD

TITLE: PROGUARD DP® - DOUBLE
 DRAINAGE PLANE PANEL DETAIL
 (PLAN VIEW)

DETAIL No:
 SS08SAT - DP2S

U140

DATE DRAWN: 16 Jan 2021	SCALE: 3"=1'-0"	DRAWN BY: TRI
----------------------------	--------------------	------------------