

THIN-CLAD CALCIUM SILICATE TILE,  
 MVIS™ HI-BOND VENEER MORTAR -  
 POLYMER FORTIFIED,  
 PROGUARD DP® INSULATED CONCRETE  
 BOARD PANEL - DOUBLE DRAINAGE  
 PLANE (THICKNESS DEPENDENT ON  
 REQUIRED R-VALUE),  
 MVIS™ AIR & WATER BARRIER or  
 WATERARMOR® AWB,  
 EXTERIOR SHEATHING,  
 STEEL STUD WALL,  
 VAPOR BARRIER (LOCATION  
 DEPENDENT ON CLIMATE ZONE),  
 GYPSUM WALLBOARD

TAPE JOINT WITH ALKALI-RESISTANT  
 MESH TAPE AND MUD JOINT WITH  
 MVIS™ HI-BOND VENEER MORTAR

INSULATION CHAMFERED AT TOP  
 AND BOTTOM OF PANEL EDGES TO  
 ALLOW FOR CONTINUOUS DRAINAGE

FLASHING MEMBRANE ADHERED MIN. 4"  
 UP SUBSTRATE. OVERLAP AIR / WATER  
 BARRIER OVER FLASHING

1'-0" x 8'-0" PROGUARD DP® BASE WEEP  
 PANEL AT ALL FLASHING LOCATIONS

LEAVE 1/8" GAP BETWEEN  
 BOTTOM OF UNIT AND FLASHING

PREFINISHED METAL DRIP EDGE  
 SET ON TWO BEADS OF  
 URETHANE SEALANT

WATERPROOFING FABRIC LEFT  
 LOOSE FOR ACCOMMODATION  
 OF SLAB EDGE MOVEMENT

MVIS™ POINTING MORTAR

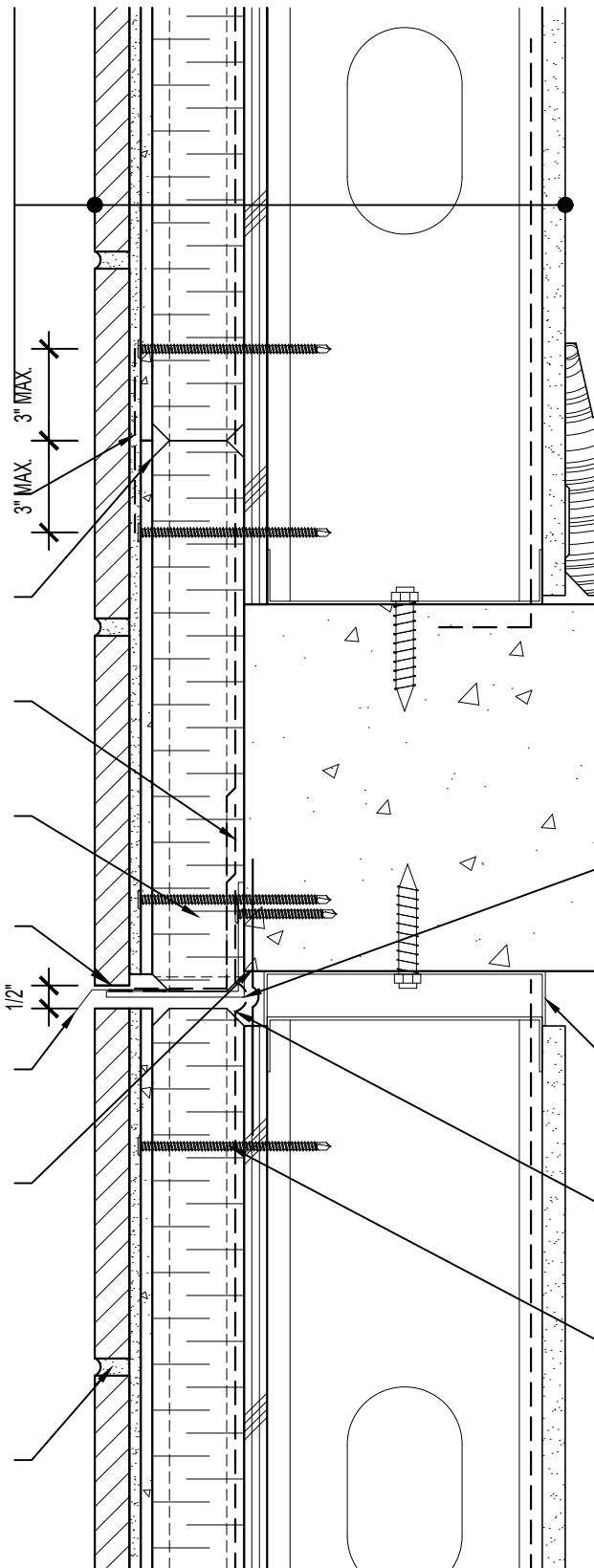

**ARCHITECT NOTE:**

- DETAIL FOR SUPPORTED PROGUARD DP® - DOUBLE DRAINAGE PLANE PANELS.
- ENGINEER OF RECORD TO SELECT PROGUARD DP® SCREW SPACING USING NTA REPORT TRIG030116-28.
- 1/2" MINIMUM DEFLECTION SPACE AT EACH FLOOR ACCOMMODATES 1/4" DISPLACEMENT. WIDER MOVEMENT JOINTS MAY BE REQUIRED BASED UPON ANTICIPATED MOVEMENTS OF STRUCTURAL ELEMENTS AND THE SEALANT PROPERTIES.
- ENSURE FASTENERS ARE 2" BELOW DEFLECTION TRACK.

16 GAUGE MIN. (G90 COATED)  
 SUPPORT ANGLE

LONG LEG OUTER TRACK ANCHORED  
 TO SLAB, NEITHER SHEATHING NOR  
 DRYWALL ATTACHED TO ALLOW FOR  
 DEFLECTION OF SLAB

COAT WATERPROOFING FABRIC  
 WITH AIR & WATER BARRIER

ATTACH PROGUARD DP® PANELS  
 WITH SILVER C APPROVED SCREWS  
 THROUGH TO STUDS (TYPICAL)



**ARRISCRAFT-CADD**

DETAIL No:  
 SS08SAT - DP2S

TITLE:

DEFLECTION SPACE DETAIL

**U082**

DATE DRAWN:

16 Jan 2021

SCALE:

3"=1'-0"

DRAWN BY:

TRI