

NOTE: REFER TO

WINDOW SILL: SS08SAT-DP2SU026
 WINDOW HEAD: SS08SAT-DP2SU032

ARCHITECT NOTE:

- DETAIL FOR SUPPORTED PROGUARD DP® - DOUBLE DRAINAGE PLANE PANELS.
- ENGINEER OF RECORD TO SELECT PROGUARD DP® SCREW SPACING USING NTA REPORT TRIG030116-28.

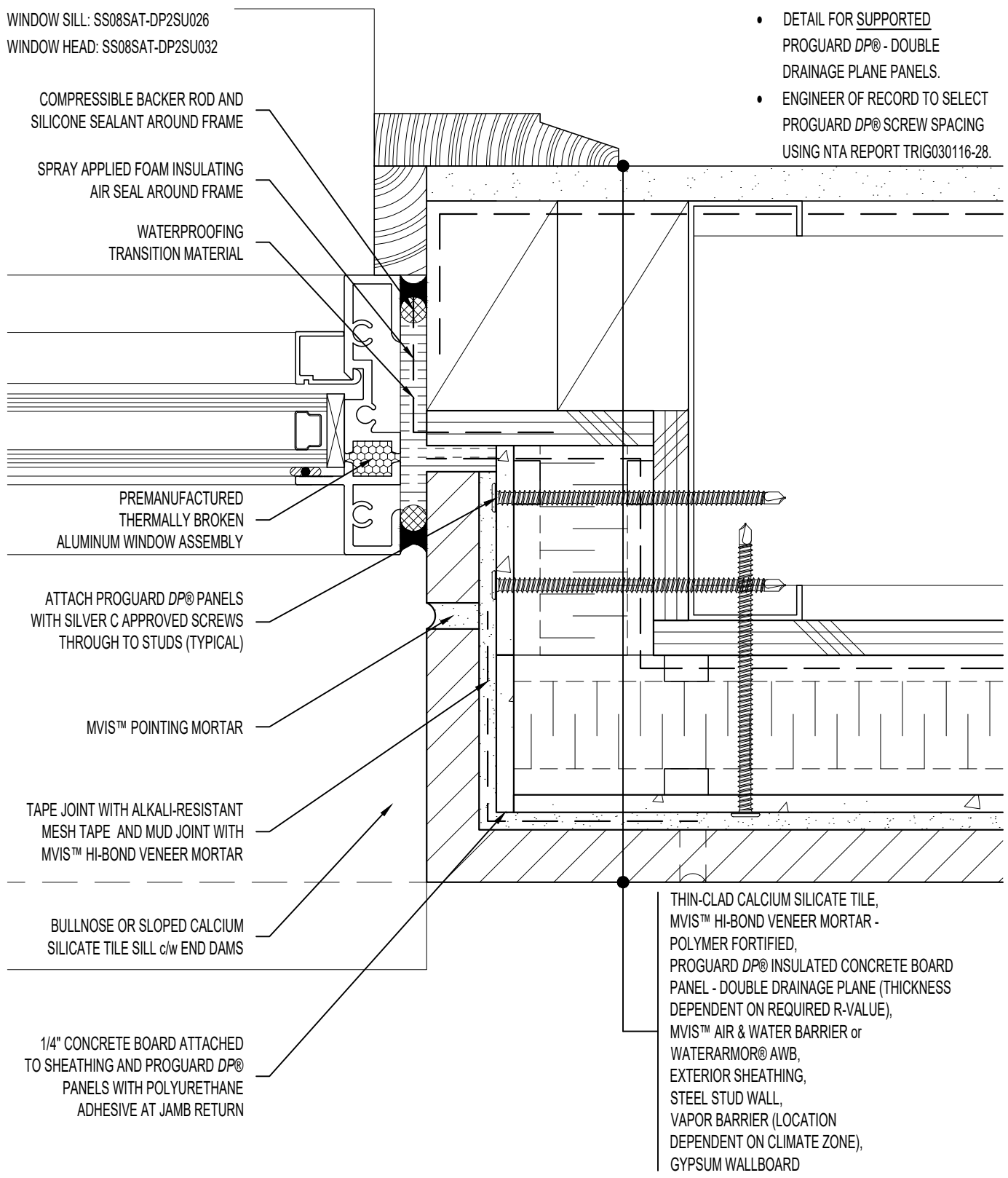

COMPRESSIBLE BACKER ROD AND SILICONE SEALANT AROUND FRAME

SPRAY APPLIED FOAM INSULATING AIR SEAL AROUND FRAME

WATERPROOFING TRANSITION MATERIAL

PREMANUFACTURED THERMALLY BROKEN ALUMINUM WINDOW ASSEMBLY

ATTACH PROGUARD DP® PANELS WITH SILVER C APPROVED SCREWS THROUGH TO STUDS (TYPICAL)

MVIS™ POINTING MORTAR

TAPE JOINT WITH ALKALI-RESISTANT MESH TAPE AND MUD JOINT WITH MVIS™ HI-BOND VENEER MORTAR

BULLNOSE OR SLOPED CALCIUM SILICATE TILE SILL c/w END DAMS

1/4" CONCRETE BOARD ATTACHED TO SHEATHING AND PROGUARD DP® PANELS WITH POLYURETHANE ADHESIVE AT JAMB RETURN

THIN-CLAD CALCIUM SILICATE TILE, MVIS™ HI-BOND VENEER MORTAR - POLYMER FORTIFIED, PROGUARD DP® INSULATED CONCRETE BOARD PANEL - DOUBLE DRAINAGE PLANE (THICKNESS DEPENDENT ON REQUIRED R-VALUE), MVIS™ AIR & WATER BARRIER or WATERARMOR® AWB, EXTERIOR SHEATHING, STEEL STUD WALL, VAPOR BARRIER (LOCATION DEPENDENT ON CLIMATE ZONE), GYPSUM WALLBOARD



ARRISCRAFT-CADD

TITLE: WINDOW JAMB WITH TILE SILL - END RETURN TILE UNIT DEEP (PLAN VIEW)

DETAIL No:
 SS08SAT - DP2S
U045

DATE DRAWN: 02 Aug 2017
 SCALE: 1-1/2"=1'-0"
 DRAWN BY: TRI