

NOTE: REFER TO

WINDOW SILL: SS08SAT-DP2SU020
 WINDOW HEAD: SS08SAT-DP2SU030

ARCHITECT NOTE:

- DETAIL FOR SUPPORTED PROGUARD DP® - DOUBLE DRAINAGE PLANE PANELS.
- ENGINEER OF RECORD TO SELECT PROGUARD DP® SCREW SPACING USING NTA REPORT TRIG030116-28.

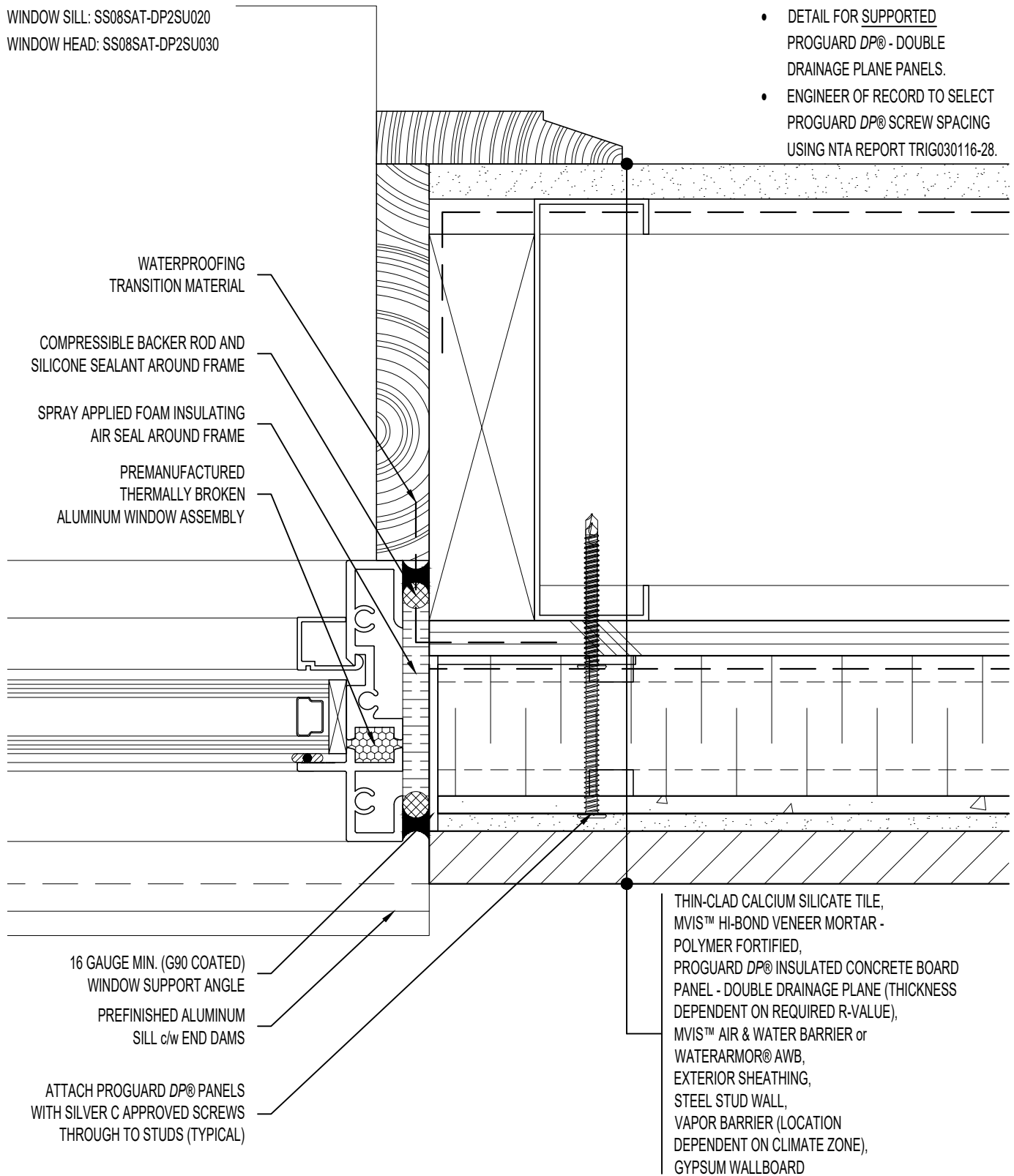

WATERPROOFING
TRANSITION MATERIAL

COMPRESSIBLE BACKER ROD AND
SILICONE SEALANT AROUND FRAME

SPRAY APPLIED FOAM INSULATING
AIR SEAL AROUND FRAME

PREMANUFACTURED
THERMALLY BROKEN
ALUMINUM WINDOW ASSEMBLY

16 GAUGE MIN. (G90 COATED)
WINDOW SUPPORT ANGLE

PREFINISHED ALUMINUM
SILL c/w END DAMS

ATTACH PROGUARD DP® PANELS
WITH SILVER C APPROVED SCREWS
THROUGH TO STUDS (TYPICAL)

THIN-CLAD CALCIUM SILICATE TILE,
MVIS™ HI-BOND VENEER MORTAR -
POLYMER FORTIFIED,
PROGUARD DP® INSULATED CONCRETE BOARD
PANEL - DOUBLE DRAINAGE PLANE (THICKNESS
DEPENDENT ON REQUIRED R-VALUE),
MVIS™ AIR & WATER BARRIER or
WATERARMOR® AWB,
EXTERIOR SHEATHING,
STEEL STUD WALL,
VAPOR BARRIER (LOCATION
DEPENDENT ON CLIMATE ZONE),
GYPSUM WALLBOARD



ARRISCRAFT-CADD

DETAIL No:
SS08SAT - DP2S

TITLE:
WINDOW JAMB WITH
ALUMINUM SILL (PLAN VIEW)

U040

DATE DRAWN:
02 Aug 2017

SCALE:
1-1/2"=1'-0"

DRAWN BY:
TRI