

NOTE: REFER TO

WINDOW HEAD: SS08SAT-DP2SU030
 WINDOW JAMB: SS08SAT-DP2SU040

ARCHITECT NOTE:

- DETAIL FOR SUPPORTED PROGUARD DP® - DOUBLE DRAINAGE PLANE PANELS.
- ENGINEER OF RECORD TO SELECT PROGUARD DP® SCREW SPACING USING NTA REPORT TRIG030116-28.

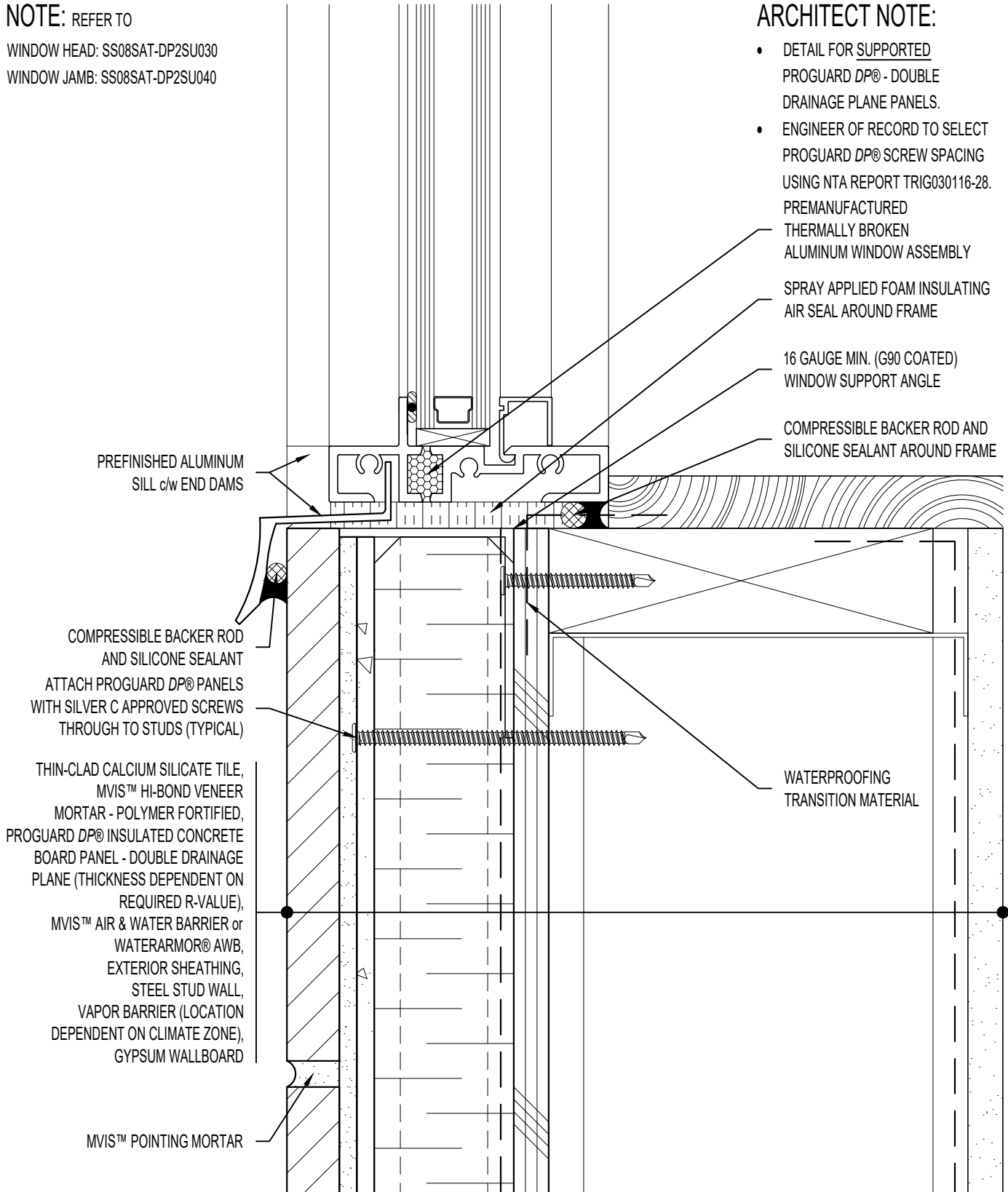

PREFINISHED ALUMINUM SILL c/w END DAMS

PREMANUFACTURED THERMALLY BROKEN ALUMINUM WINDOW ASSEMBLY
 SPRAY APPLIED FOAM INSULATING AIR SEAL AROUND FRAME
 16 GAUGE MIN. (G90 COATED) WINDOW SUPPORT ANGLE
 COMPRESSIBLE BACKER ROD AND SILICONE SEALANT AROUND FRAME

COMPRESSIBLE BACKER ROD AND SILICONE SEALANT ATTACH PROGUARD DP® PANELS WITH SILVER C APPROVED SCREWS THROUGH TO STUDS (TYPICAL)

THIN-CLAD CALCIUM SILICATE TILE, MVIS™ HI-BOND VENEER MORTAR - POLYMER FORTIFIED, PROGUARD DP® INSULATED CONCRETE BOARD PANEL - DOUBLE DRAINAGE PLANE (THICKNESS DEPENDENT ON REQUIRED R-VALUE), MVIS™ AIR & WATER BARRIER or WATERARMOR® AWB, EXTERIOR SHEATHING, STEEL STUD WALL, VAPOR BARRIER (LOCATION DEPENDENT ON CLIMATE ZONE), GYPSUM WALLBOARD

WATERPROOFING TRANSITION MATERIAL

MVIS™ POINTING MORTAR



ARRISCRAFT-CADD

DETAIL No:
 SS08SAT - DP2S

TITLE:
 ALUMINUM WINDOW SILL

U020

DATE DRAWN: 16 Jan 2021	SCALE: 1-1/2"=1'-0"	DRAWN BY: TRI
----------------------------	------------------------	------------------