

THIN-CLAD CALCIUM SILICATE TILE,  
 MVIS™ HI-BOND VENEER MORTAR -  
 POLYMER FORTIFIED,  
 PROGUARD DP® INSULATED CONCRETE  
 BOARD PANEL - DOUBLE DRAINAGE  
 PLANE (THICKNESS DEPENDENT ON  
 REQUIRED R-VALUE),  
 MVIS™ AIR & WATER BARRIER or  
 WATERARMOR® AWB,  
 EXTERIOR SHEATHING,  
 STEEL STUD WALL,  
 VAPOR BARRIER (LOCATION  
 DEPENDENT ON CLIMATE ZONE),  
 GYPSUM WALLBOARD

MVIS™ POINTING MORTAR  
 ATTACH PROGUARD DP® PANELS  
 WITH SILVER C APPROVED SCREWS  
 THROUGH TO STUDS (TYPICAL)  
 TAPE JOINT WITH ALKALI-RESISTANT  
 MESH TAPE AND MUD JOINT WITH  
 MVIS™ HI-BOND VENEER MORTAR

EMBED FLASHING TAPE IN AIR /  
 WATER BARRIER AT SUPPORT  
 ANGLE TRANSITION. OVERLAP AIR /  
 WATER BARRIER OVER ANGLE  
 16 GAUGE MIN. (G90 COATED)  
 SUPPORT ANGLE  
 LEAVE 1/8" GAP BETWEEN  
 BOTTOM OF UNIT AND FLASHING  
 PREFINISHED METAL FLASHING  
 w/ DRIP EDGE SET ON TWO  
 BEADS OF URETHANE SEALANT

PARGING  
 6" MIN.  
 COMPRESSIBLE BACKER ROD  
 AND SILICONE SEALANT  
 PREMOLDED EXPANSION JOINT FILLER  
 2% SLOPE MIN.

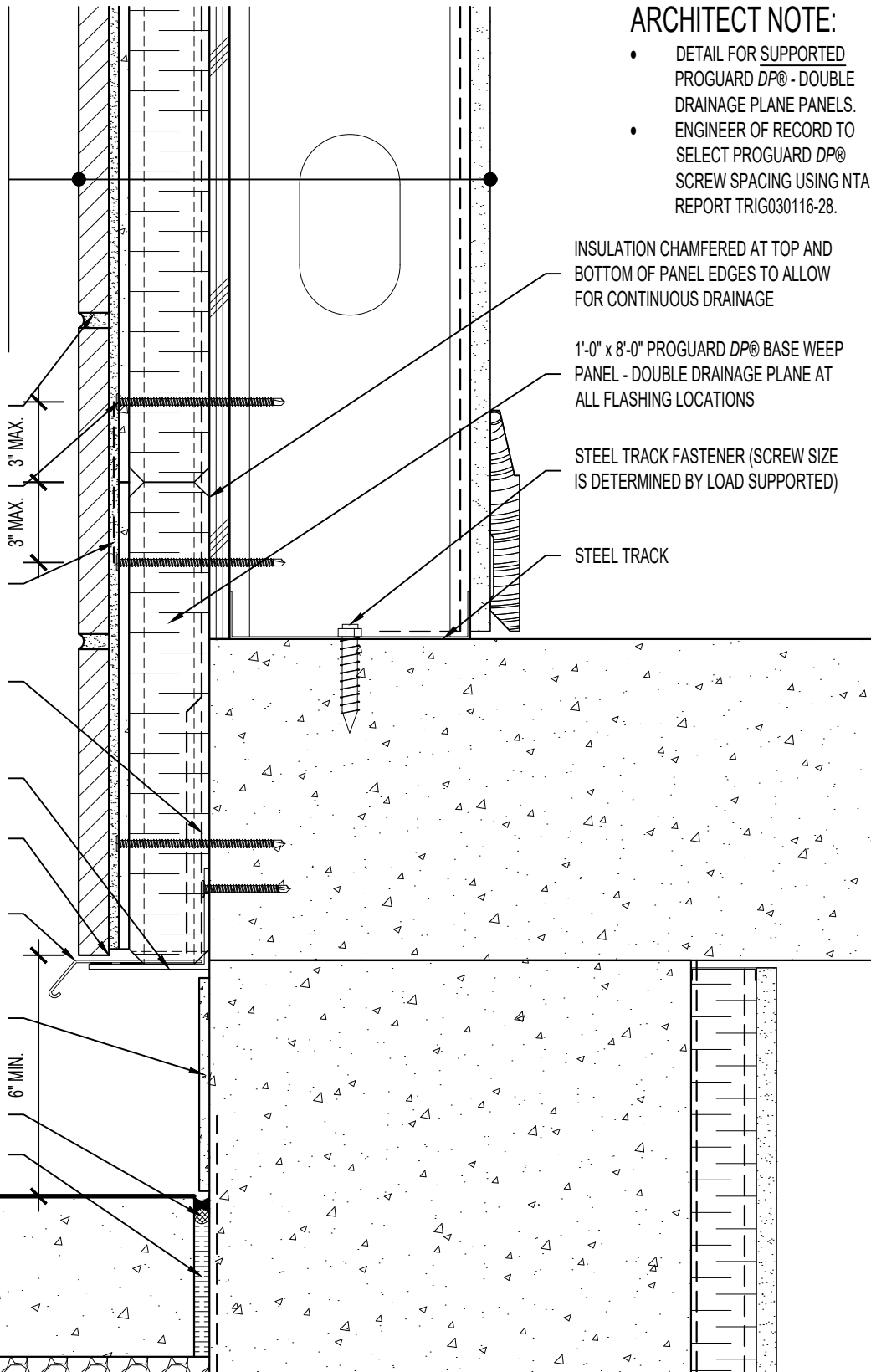

**ARCHITECT NOTE:**

- DETAIL FOR SUPPORTED PROGUARD DP® - DOUBLE DRAINAGE PLANE PANELS.
- ENGINEER OF RECORD TO SELECT PROGUARD DP® SCREW SPACING USING NTA REPORT TRIG030116-28.

INSULATION CHAMFERED AT TOP AND BOTTOM OF PANEL EDGES TO ALLOW FOR CONTINUOUS DRAINAGE  
 1'-0" x 8'-0" PROGUARD DP® BASE WEEP PANEL - DOUBLE DRAINAGE PLANE AT ALL FLASHING LOCATIONS  
 STEEL TRACK FASTENER (SCREW SIZE IS DETERMINED BY LOAD SUPPORTED)  
 STEEL TRACK



**ARRISCRAFT-CADD**

DETAIL No:  
 SS08SAT - DP2S

TITLE:  
 ALTERNATIVE FOUNDATION TO  
 WALL JUNCTION WITH PAVING

**U009**

DATE DRAWN: 02 Aug 2017  
 SCALE: 3"=1'-0"  
 DRAWN BY: TRI