

**NOTE: REFER TO**  
**DOOR JAMB: SS08SUAC071**  
**DOOR THRESHOLD: SS08SUAC051**

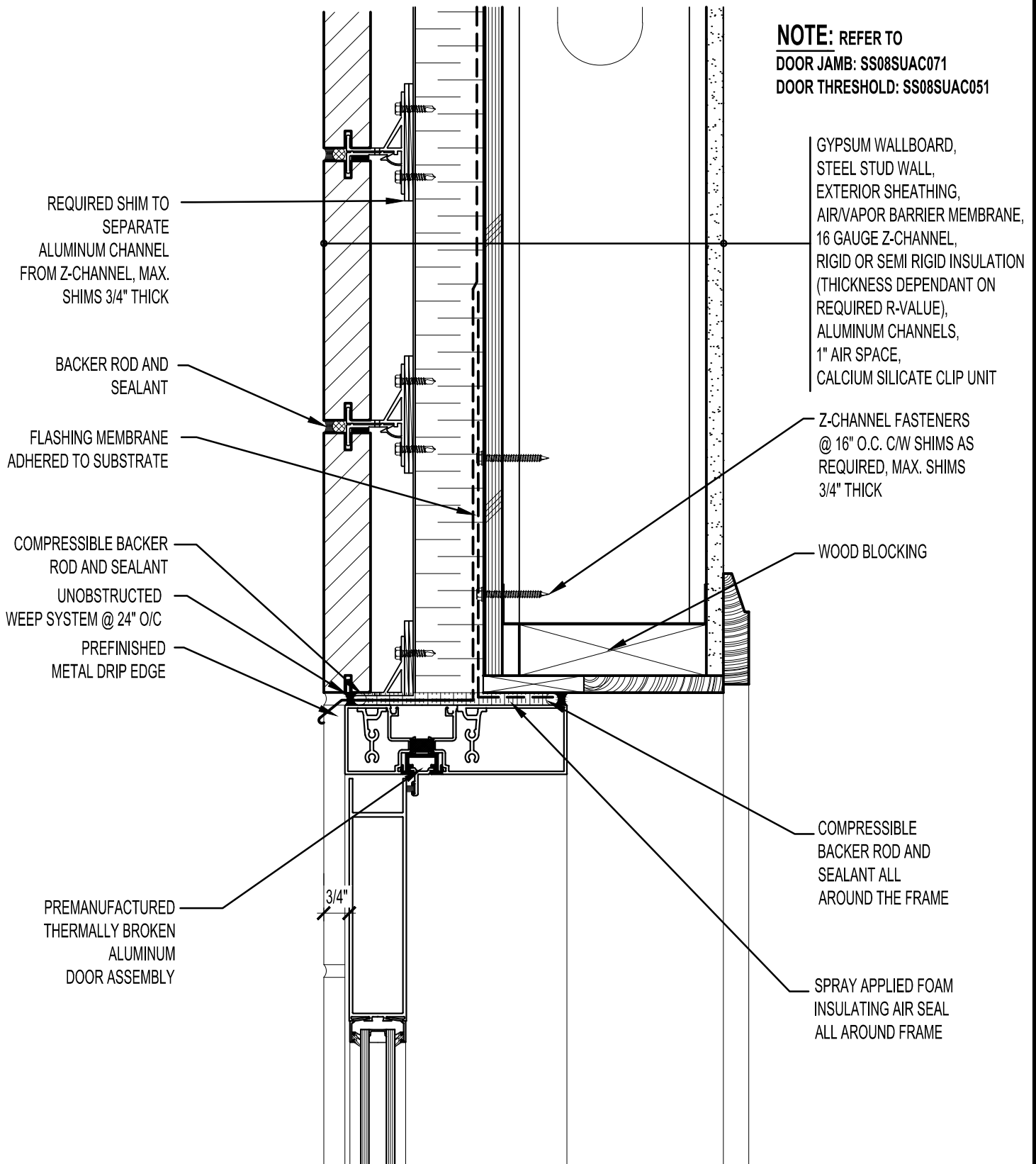

GYPSUM WALLBOARD,  
 STEEL STUD WALL,  
 EXTERIOR SHEATHING,  
 AIR/VAPOR BARRIER MEMBRANE,  
 16 GAUGE Z-CHANNEL,  
 RIGID OR SEMI RIGID INSULATION  
 (THICKNESS DEPENDANT ON  
 REQUIRED R-VALUE),  
 ALUMINUM CHANNELS,  
 1" AIR SPACE,  
 CALCIUM SILICATE CLIP UNIT

Z-CHANNEL FASTENERS  
 @ 16" O.C. C/W SHIMS AS  
 REQUIRED, MAX. SHIMS  
 3/4" THICK

WOOD BLOCKING

COMPRESSIBLE  
 BACKER ROD AND  
 SEALANT ALL  
 AROUND THE FRAME

SPRAY APPLIED FOAM  
 INSULATING AIR SEAL  
 ALL AROUND FRAME

REQUIRED SHIM TO  
 SEPARATE  
 ALUMINUM CHANNEL  
 FROM Z-CHANNEL, MAX.  
 SHIMS 3/4" THICK

BACKER ROD AND  
 SEALANT

FLASHING MEMBRANE  
 ADHERED TO SUBSTRATE

COMPRESSIBLE BACKER  
 ROD AND SEALANT  
 UNOBSTRUCTED  
 WEEP SYSTEM @ 24" O/C  
 PREFINISHED  
 METAL DRIP EDGE

PREMANUFACTURED  
 THERMALLY BROKEN  
 ALUMINUM  
 DOOR ASSEMBLY

**ARRISCRAFT • CADD**

DATE DRAWN:  
01/15/12

DETAIL No:  
SS 08SU

TITLE:  
ALUMINUM DOOR  
HEAD - DOOR @ KERF

SCALE:  
3"=1'-0"

DRAWN BY:  
D.D.N.

**AC061**



**ARRISCRAFT**  
 INTERNATIONAL  
 BUILDING STONE • BRICK • LIMESTONE