

NOTE: REFER TO
WINDOW HEAD: SS08SUAC030
WINDOW SILL: SS08SUAC021-22

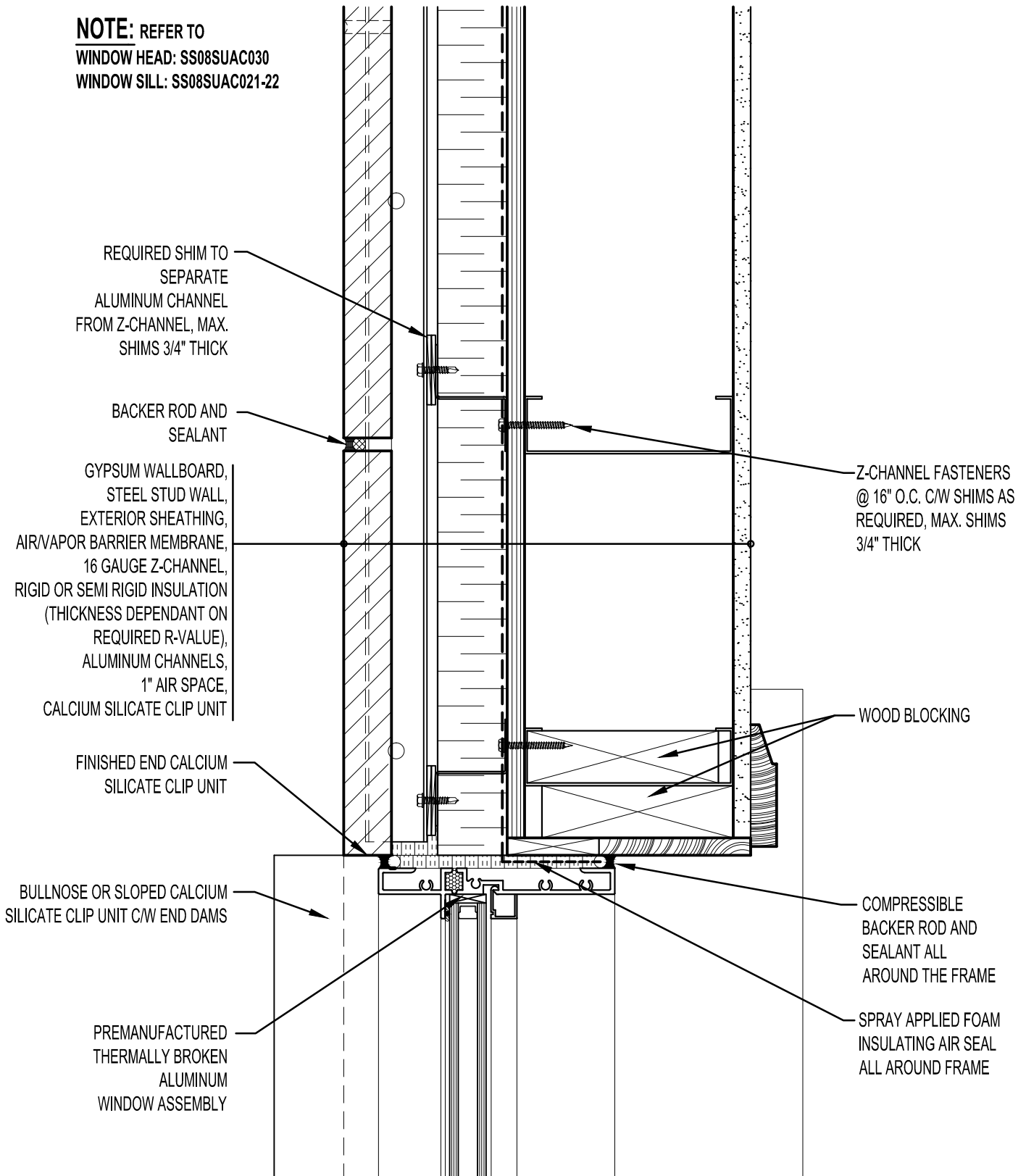

REQUIRED SHIM TO SEPARATE ALUMINUM CHANNEL FROM Z-CHANNEL, MAX. SHIMS 3/4" THICK

BACKER ROD AND SEALANT

GYPSUM WALLBOARD, STEEL STUD WALL, EXTERIOR SHEATHING, AIR/VAPOR BARRIER MEMBRANE, 16 GAUGE Z-CHANNEL, RIGID OR SEMI RIGID INSULATION (THICKNESS DEPENDANT ON REQUIRED R-VALUE), ALUMINUM CHANNELS, 1" AIR SPACE, CALCIUM SILICATE CLIP UNIT

FINISHED END CALCIUM SILICATE CLIP UNIT

BULLNOSE OR SLOPED CALCIUM SILICATE CLIP UNIT C/W END DAMS

PREMANUFACTURED THERMALLY BROKEN ALUMINUM WINDOW ASSEMBLY

Z-CHANNEL FASTENERS @ 16" O.C. C/W SHIMS AS REQUIRED, MAX. SHIMS 3/4" THICK

WOOD BLOCKING

COMPRESSIBLE BACKER ROD AND SEALANT ALL AROUND THE FRAME

SPRAY APPLIED FOAM INSULATING AIR SEAL ALL AROUND FRAME



ARRISCRAFT
 INTERNATIONAL
 BUILDING STONE • BRICK • LIMESTONE

ARRISCRAFT • CADD

TITLE:
**WINDOW JAMB WITH CLIP SILL
 (PLAN VIEW)**

DATE DRAWN:
 01/15/12

SCALE:
 3"=1'-0"

DRAWN BY:
 D.D.N.

DETAIL No:
 SS 08SU

AC043