

CALCIUM SILICATE MASONRY
UNIT (CSMU),
MIN. 1" AIR SPACE,
RIGID OR SEMI-RIGID
INSULATION (THICKNESS
DEPENDANT ON REQUIRED
R-VALUE),
AIR/VAPOR BARRIER
MEMBRANE,
EXTERIOR SHEATHING,
STEEL STUD WALL,
GYPSUM WALLBOARD.

STEEL TRACK FASTENER
(SCREW SIZE IS
DETERMINED BY
LOAD SUPPORTED)

STEEL TRACK

MORTAR DROP
CONTROL

FLASHING MEMBRANE
SURFACE ADHERE
TO SUBSTRATE

UNOBSTRUCTED
WEEP SYSTEM @ 24" O/C

PREFINISHED
METAL DRIP EDGE
SET ON TWO
BEADS OF SEALANT

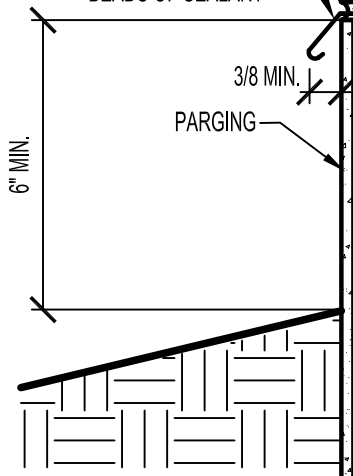

AIR/VAPOR BARRIER
BUILDING PAPER
STEEL STUD
FURRING WITH
INSULATION
GYPSUM
WALLBOARD



ARRISCRAFT
INTERNATIONAL
BUILDING STONE • BRICK • LIMESTONE

ARRISCRAFT • CADD

TITLE:

ALTERNATIVE FOUNDATION
TO WALL JUNCTION WITH SOIL

DATE DRAWN:

08/30/04

SCALE:

3"=1'-0"

DRAWN BY:

LPS

DETAIL No:

SS 08R

U002