

**NOTE:** REFER TO  
**WINDOW HEAD: SS08RUAC032**  
**WINDOW SILL: SS08RUAC020**

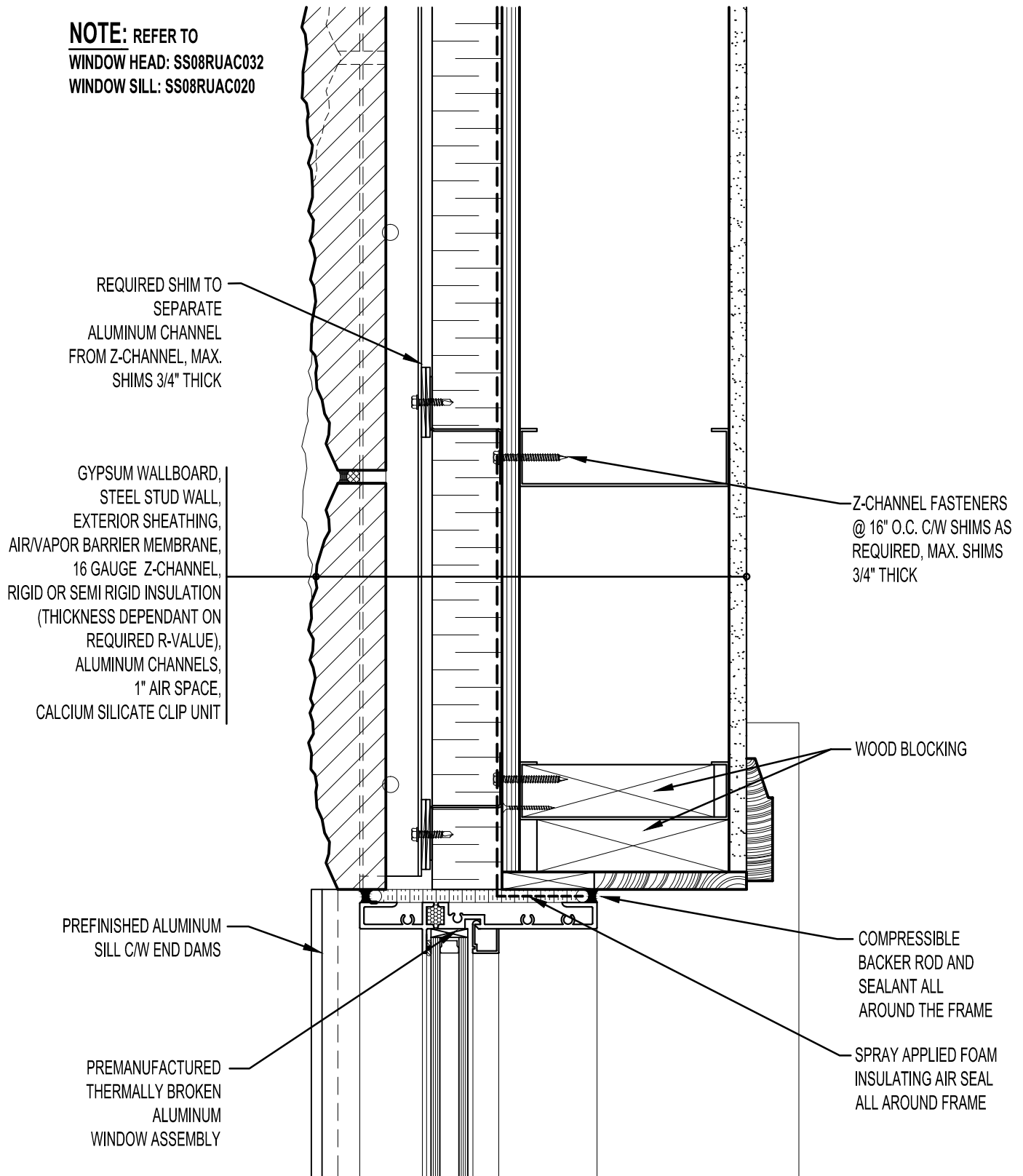

REQUIRED SHIM TO SEPARATE ALUMINUM CHANNEL FROM Z-CHANNEL, MAX. SHIMS 3/4" THICK

GYPSUM WALLBOARD,  
 STEEL STUD WALL,  
 EXTERIOR SHEATHING,  
 AIR/VAPOR BARRIER MEMBRANE,  
 16 GAUGE Z-CHANNEL,  
 RIGID OR SEMI RIGID INSULATION  
 (THICKNESS DEPENDANT ON  
 REQUIRED R-VALUE),  
 ALUMINUM CHANNELS,  
 1" AIR SPACE,  
 CALCIUM SILICATE CLIP UNIT

Z-CHANNEL FASTENERS @ 16" O.C. C/W SHIMS AS REQUIRED, MAX. SHIMS 3/4" THICK

WOOD BLOCKING

PREFINISHED ALUMINUM SILL C/W END DAMS

COMPRESSIBLE BACKER ROD AND SEALANT ALL AROUND THE FRAME

PREMANUFACTURED THERMALLY BROKEN ALUMINUM WINDOW ASSEMBLY

SPRAY APPLIED FOAM INSULATING AIR SEAL ALL AROUND FRAME



**ARRISCRAFT**  
 INTERNATIONAL  
 BUILDING STONE • BRICK • LIMESTONE

**ARRISCRAFT • CADD**

TITLE:  
**WINDOW JAMB WITH ALUMINUM SILL**  
**- WINDOW @ KERF (PLAN VIEW)**

DATE DRAWN:  
 01/15/12

SCALE:  
 3"=1'-0"

DRAWN BY:  
 D.D.N.

DETAIL No:  
 SS 08RU

**AC041**