

NOTE: REFER TO
 WINDOW HEAD: SS08RUAC031
 WINDOW JAMB: SS08RUAC042

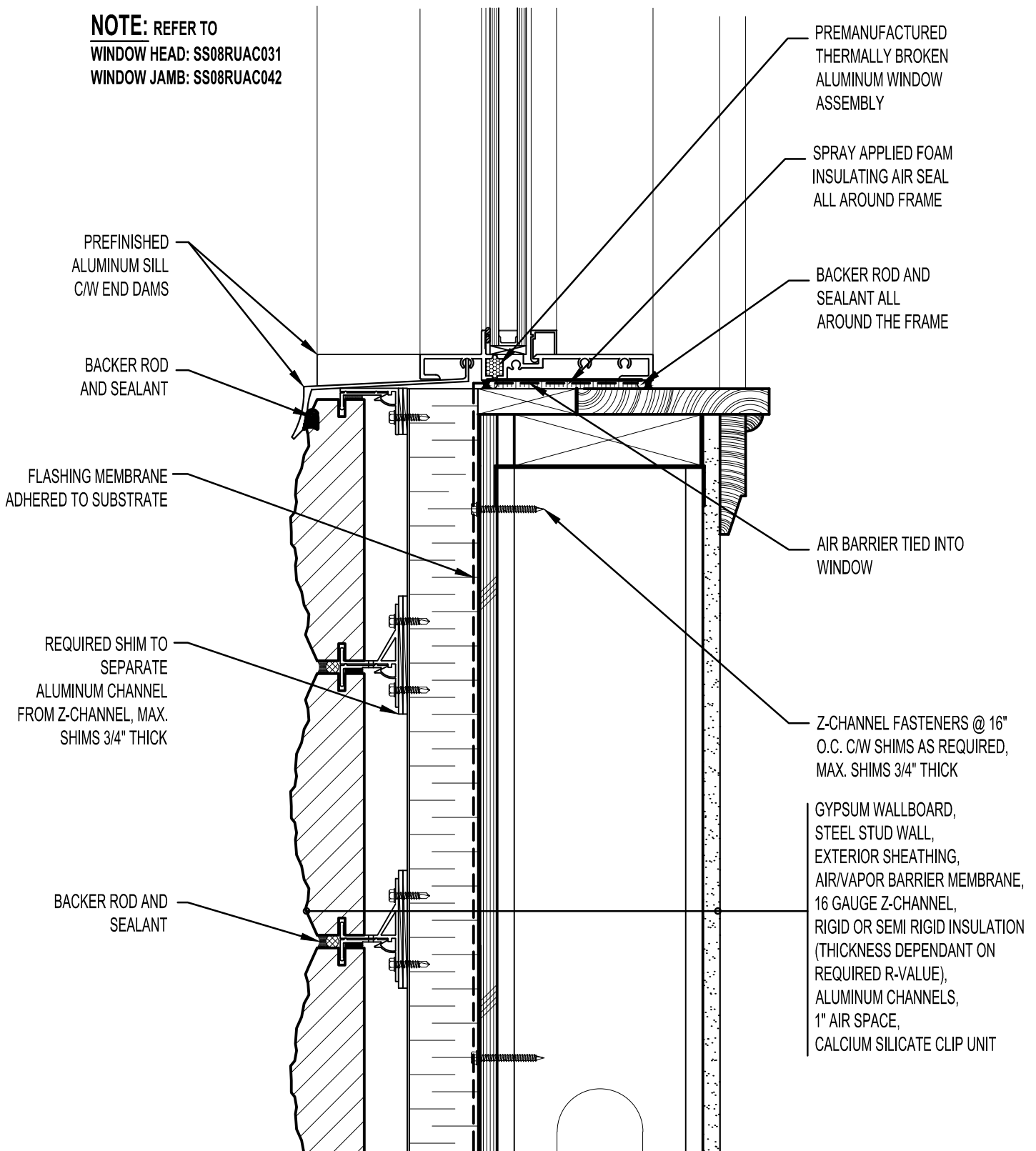

PREMANUFACTURED THERMALLY BROKEN ALUMINUM WINDOW ASSEMBLY

SPRAY APPLIED FOAM INSULATING AIR SEAL ALL AROUND FRAME

BACKER ROD AND SEALANT ALL AROUND THE FRAME

AIR BARRIER TIED INTO WINDOW

Z-CHANNEL FASTENERS @ 16" O.C. C/W SHIMS AS REQUIRED, MAX. SHIMS 3/4" THICK

GYPSUM WALLBOARD, STEEL STUD WALL, EXTERIOR SHEATHING, AIR/VAPOR BARRIER MEMBRANE, 16 GAUGE Z-CHANNEL, RIGID OR SEMI RIGID INSULATION (THICKNESS DEPENDANT ON REQUIRED R-VALUE), ALUMINUM CHANNELS, 1" AIR SPACE, CALCIUM SILICATE CLIP UNIT

PREFINISHED ALUMINUM SILL C/W END DAMS

BACKER ROD AND SEALANT

FLASHING MEMBRANE ADHERED TO SUBSTRATE

REQUIRED SHIM TO SEPARATE ALUMINUM CHANNEL FROM Z-CHANNEL, MAX. SHIMS 3/4" THICK

BACKER ROD AND SEALANT



ARRISCRAFT
 INTERNATIONAL
 BUILDING STONE • BRICK • LIMESTONE

ARRISCRAFT • CADD

TITLE:
 ALUMINUM WINDOW
 SILL - RECESSED WINDOW

DATE DRAWN:
 01/15/12

SCALE:
 3"=1'-0"

DRAWN BY:
 D.D.N.

DETAIL No:
 SS 08RU

AC026