

ADAIR® LIMESTONE
 MASONRY UNIT,
 MIN. 25 MM AIR SPACE,
 RIGID OR SEMI-RIGID INSULATION
 (THICKNESS DEPENDANT ON
 REQUIRED R-VALUE),
 AIR/VAPOUR BARRIER
 MEMBRANE,
 CONCRETE MASONRY UNIT (CMU),
 METAL FURRING (OPTIONAL),
 GYPSUM WALLBOARD.

PREMANUFACTURED
 THERMALLY BROKEN
 ALUMINUM DOOR ASSEMBLY

SEALANT BEADS FOR
 MOISTURE PROTECTION
 SLOPE SILL AWAY TO
 ENSURE WATER DRAINAGE

COMPRESSIBLE
 BACKER ROD
 AND SEALANT
 FLOOR BY OTHER

FLASHING MEMBRANE
 SURFACE ADHERE
 TO SUBSTRATE

PARGING
 COMPRESSIBLE BACKER
 ROD AND SEALANT
 PREMOULDED EXPANSION
 JOINT FILLER
 2% SLOPE MIN.

AIR/VAPOUR BARRIER
 BUILDING PAPER

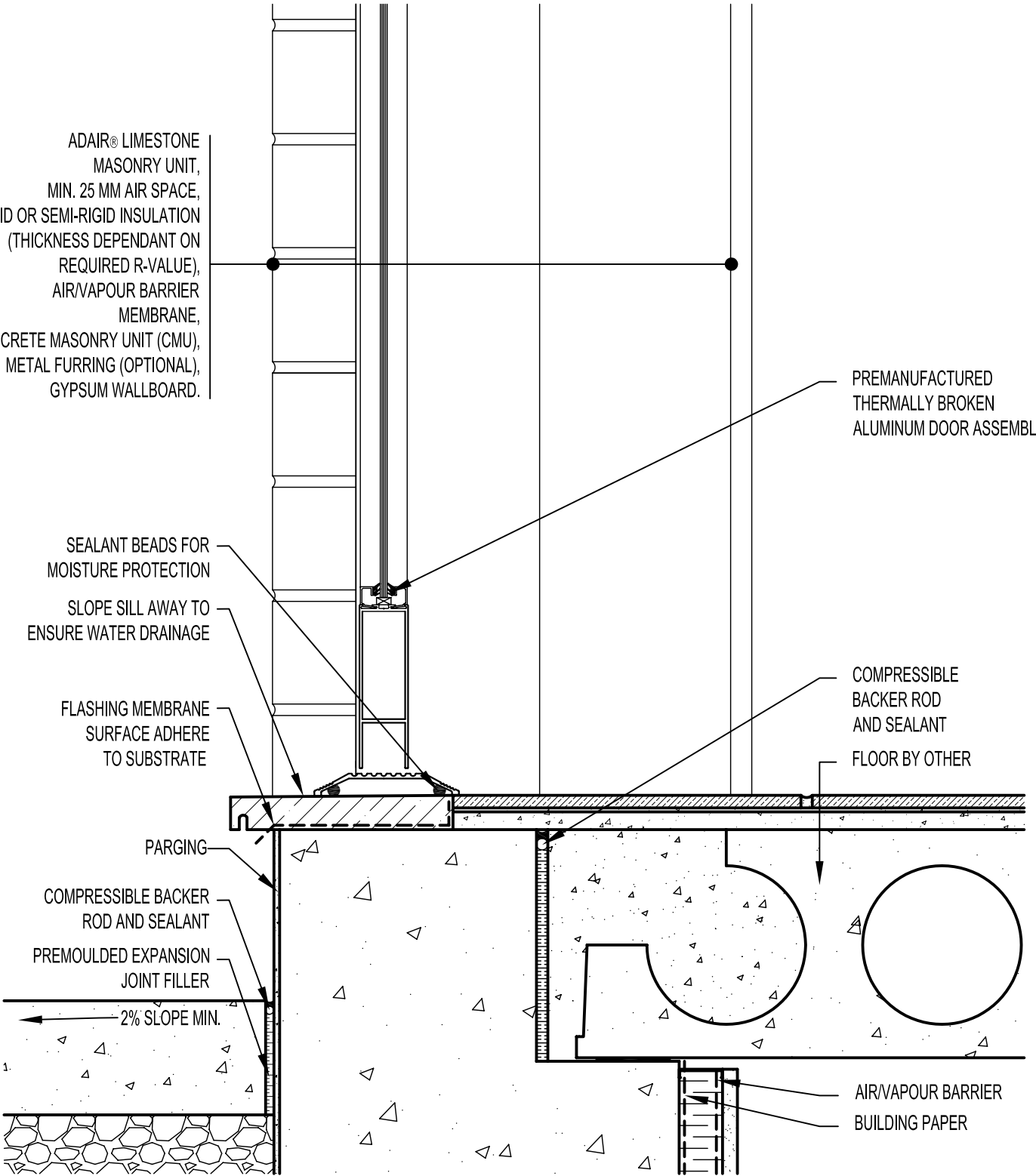

ARRISCRAFT
 INTERNATIONAL
 BUILDING STONE • BRICK • LIMESTONE

ARRISCRAFT • CADD

TITLE:
 THRESHOLD OF DOOR

DATE DRAWN:
 08/30/04

SCALE:
 1:5

DRAWN BY:
 LPS

DETAIL No:
 CB AD09S

D050