

Block

- 3 bags mortar per 100 block
- 1000 lbs of sand per 100 block
- 1.125 block per sq. ft. wall
- ASTM Specification C90

Mortar

- Typical walls (above grade) use Type N
- Below grade and block foundations use Type S
- Pavers use Type S
- 1 part masonry cement mortar: 3 parts sand
- ASTM Specification C270

Brick

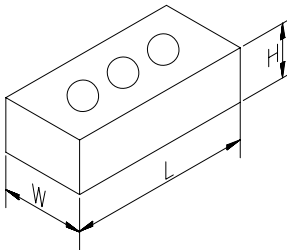

	Modular (M/S)	Engineer Modular (E/M)	Queen Size (Q/M)	King Size (K/S)
Size W x H x L (Bed x Face x Length)	3½" x 2¼" x 7 ⅝"	3½" x 2¾" x 7 ⅝"	3" x 2¾" x 7 ⅝"	2⅝" x 2¾" x 9 ⅝"
Brick Per Sq. Ft. of Wall *	6.75	5.76	5.76	4.6
Bags of Mortar per 1000 brick	7	8	6.5	7
Wall Ties per 1000 brick	55	65	65	80
Package Count	480	380	460	368

* Add approximately 5% for waste.

Sand

- Order 1 ton of sand for every 7 bags of masonry cement mortar
- ASTM Specification C144

Pavers

- 4.5 Pavers per sq. ft.
- 2” sand setting bed, 1 ton covers 110 sq. ft.
- 4” compacted base, 1 ton covers 43.5 sq ft
- ASTM Specification C902 (Pedestrian and Light Traffic 2¼” and 1¼” units) & C1272 (Heavy Vehicular 2⅝” units)

Sealers and Cleaners

ProSoCo Products

- Weatherseal Siloxane PD™ 1 gallon per 125 sq. ft. surface area
- Paver Enhancer™ 1 gallon per 125 sq. ft. surface area
- Sure Clean 600™ or Vanatrol™ 1 gallon (undiluted) per 5000 brick

Weeps

- Order 1 weep for every 2 linear feet of base course, above and below all openings
- Order weeps for roof intersections on pre-fab chimneys

Lintels

- Minimum length = Masonry Opening plus 8” (Openings up to 6 feet)
Minimum length = Masonry Opening plus 12” (Openings between 6 to 9 feet)
Minimum length = Masonry Opening plus 24” (Openings greater than 9 feet)
- Lintels are ordered in 6” length increments (order next size up)
- For vinyl windows the out to out dimension is the same as the masonry opening

Flashing

- Around base course
- Above and below all window and door openings (double lintel length)

Landscaping Coverage

(coverage per ton in sq. ft.)

<u>Depth</u>	<u>Brick Chips</u>	<u>Garden Trak</u>
1”	300 sq. ft.	280 sq. ft.
2”	150 sq. ft.	140 sq. ft.
3”	100 sq. ft.	93 sq. ft.
4”	75 sq. ft.	70 sq. ft.
5”	60 sq. ft.	56 sq. ft.
6”	50 sq. ft.	47 sq. ft.

Thin Brick / Thin Rock Mortar

- Scratch Coat 2 bags mortar per 100 sq. ft. (brick and rock)
- Grouting Joints 1 bag mortar per 100 sq. ft. (brick)
2 bags mortar per 100 sq. ft (rock)