

How-To Assemble Your
SENTINEL
Mailbox

PART NO. MBX-100

DIFFICULTY NOVICE

APPROX. DIM. 2'W x 2'D x 5'2" H

APPROX. WEIGHT 1,700 lbs.



GENERAL SHALE OUTDOOR LIVING PRODUCT WARRANTY

All General Shale Outdoor Living products are warranted to be made from high quality materials that meet or exceed ASTM material standards. Outdoor Living products are intended for recreational or residential use and are not warranted for any other purpose. The life of the product depends on correctness of installation and extent of usage. All metal components are subject to normal rust and corrosion.

ANY IMPLIED WARRANTIES ARE HEREBY DISCLAIMED AND ARE EXPRESSLY EXCLUDED.

Materials included with your outdoor kit.

- (46) Block “A” (4" x 8" x 16")
- (4) Block “A1” (4" x 6 1/2" x 16")
- (4) Block “A2” (4" x 8" x 16"; special cut)
- (4) Bullnose Block “A3” (4" x 5 1/2" x 14")
- (2) Block “I” (2 1/4" x 8" x 10")
- (8) Bullnose Corner Block “C1” (4" x 8" x 8")
- (12) Bullnose Block “C2” (4" x 5 3/4" x 8")
- (4) Block "C3" (4" x 6 1/2" x 8")
- (2) Block "C4" (4" x 8" x 8")
- (1) Newspaper Box
- (1) Mail box
- (1) Thin Set Mix Bag
- (1) Mailbox flag*
(*Insert bracket between block courses at desired location)

Course Numbers
(Referred to in following instructions)

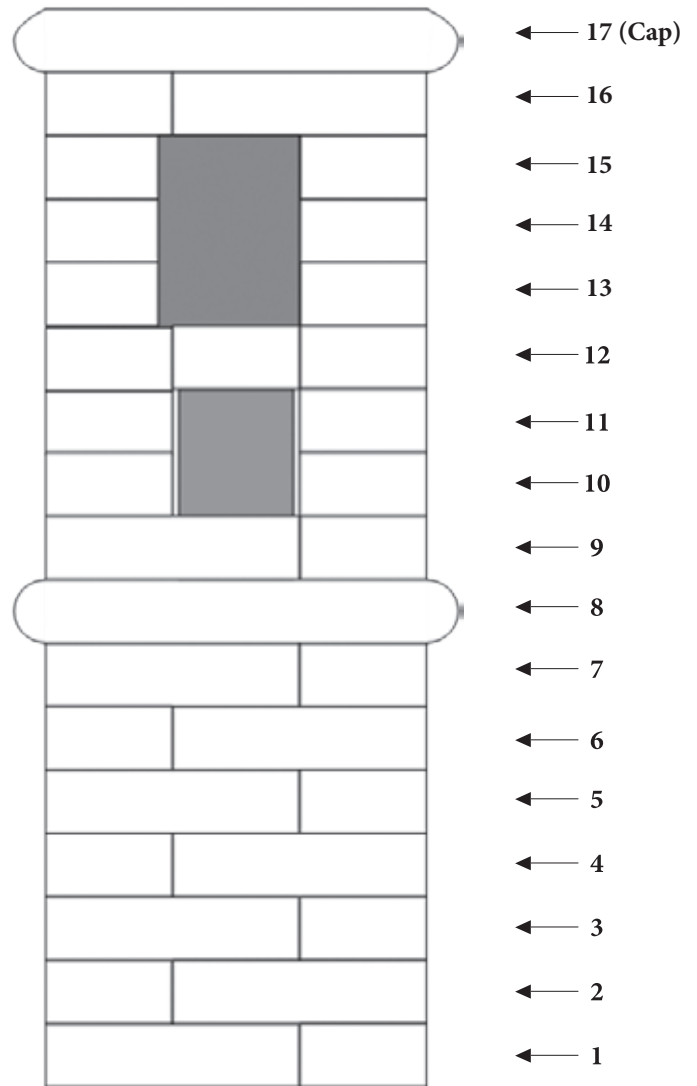

Additional materials required to install your kit.

- Concrete or Gravel (for setting base)
- Level
- Tape Measure
- Rubber Mallet
- *Note: You may also use landscape adhesive (available separately) in place of supplied thin set mix.*

**Step
1**

Create a level base using Crusher Run Stone to accommodate the overall footprint of the mailbox.

- Prepare an area 2'6" wide x 2'6" deep.
- Remove sod and vegetation.
- Excavate/remove soft soil as required to provide level stone surface at a minimum of 4" deep.
- If required, use landscape blocks to retain stone base.
- If installing optional hearth/knee wall, extend base as required.



If soil under sod is hard, soil can be leveled out and used as a base material.

Reference diagrams for creating a level base.

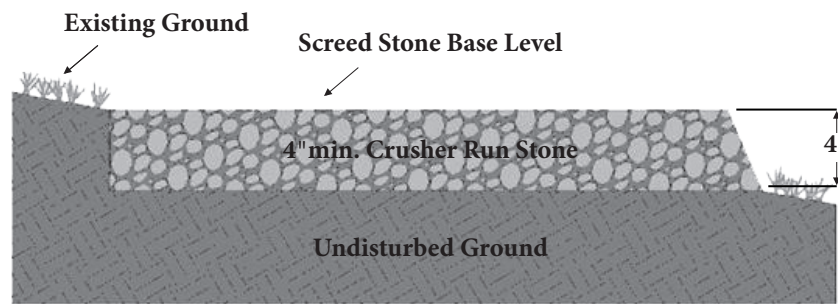

(Base Section View)

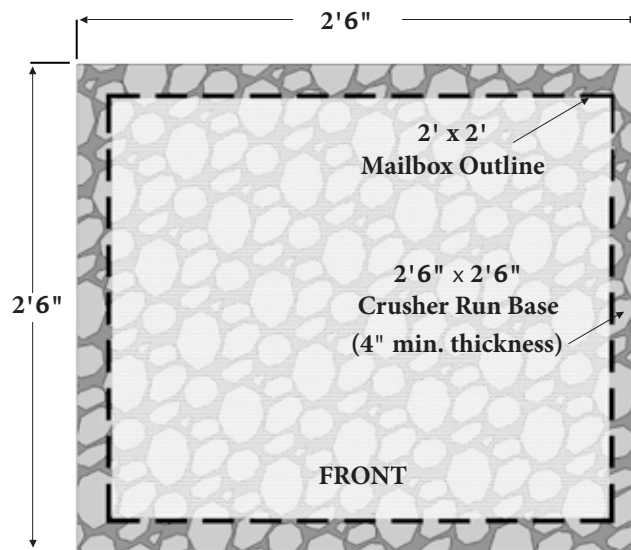

(Base Plan View)

NOTE: All outdoor living kits can be installed directly on a properly prepared stone base. However, for best performance and appearance, a concrete pad is recommended.

**Step
2**

Build the mailbox (courses 1 through 4).

- Assemble the mailbox on a level setting base.

TIP *After laying the first course, check to make sure it is level before proceeding.*

- Use supplied thin set between all courses and all block.

TIP *Apply thin set to the inside of block to prevent excess from squeezing out onto the face of the mailbox using a 1/4" notch trowel.*

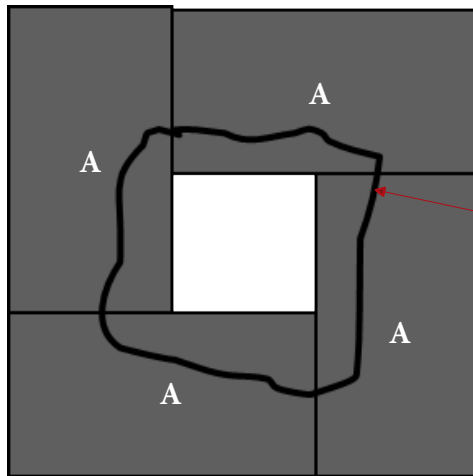

Thin Set
(NOTE: This step occurs at each course).

Courses 1 and 3

(4) Block “A” (4" x 8" x 16")

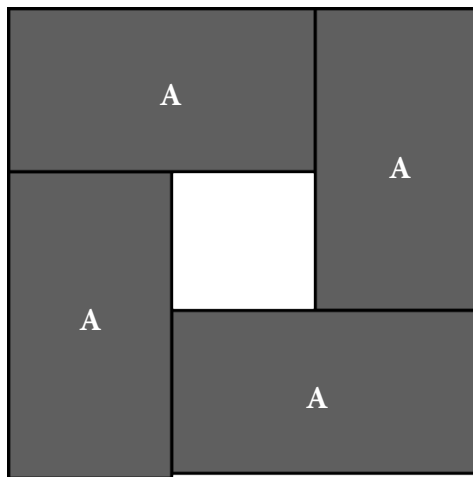

Courses 2 and 4

(4) Block “A” (4" x 8" x 16")

**Step
3**

Build the mailbox (courses 5 through 7).

- Use supplied thin set between all courses and all block.



Apply thin set to the inside of block to prevent excess from squeezing out onto the face of the mailbox.

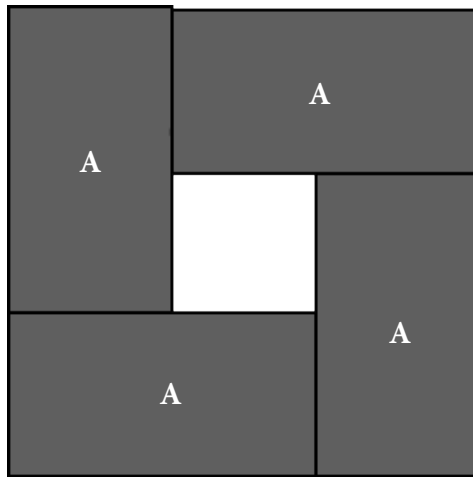

Courses 5 and 7

(4) Block “A” (4" x 8" x 16")

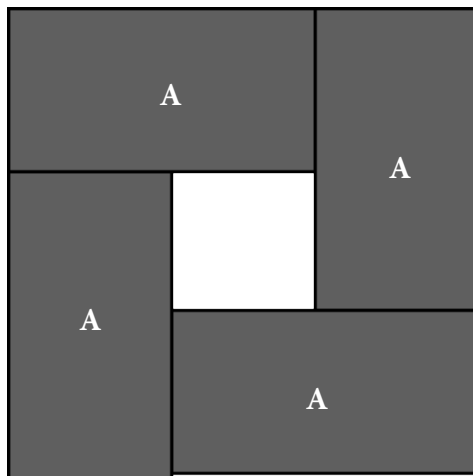

Course 6

(4) Block “A” (4" x 8" x 16")

**Step
4**

Build the mailbox (courses 8 and 9).

- Use supplied thin set between all courses and all block.

TIP *Apply thin set to the inside of block to prevent excess from squeezing out onto the face of the mailbox.*

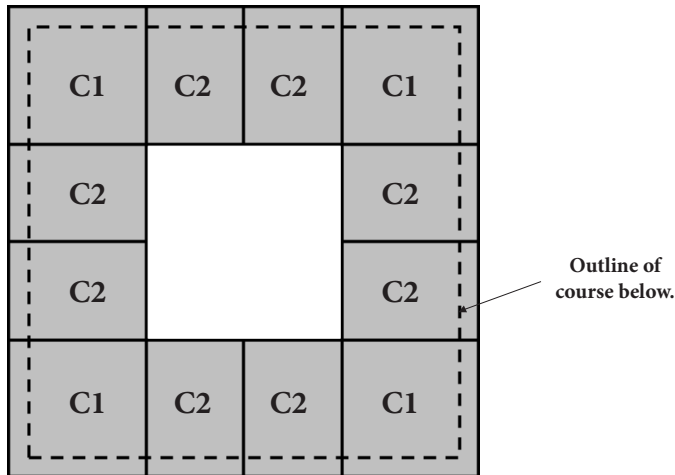

Course 8

(4) Corner Block “C1” (4" x 8" x 8")

(8) Block “C2” (4" x 5 3/4" x 8")

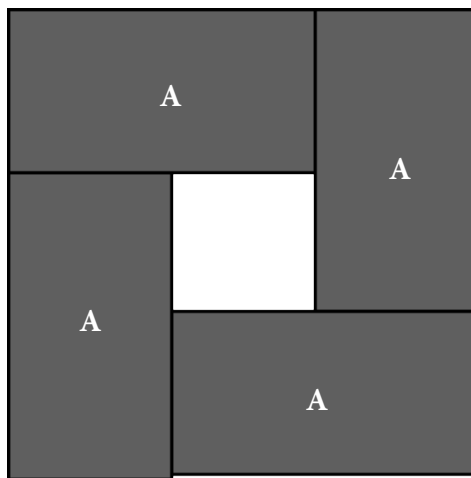

Course 9

(4) Block “A” (4" x 8" x 16")

**Step
5**

Build the mailbox (courses 10 and 11).

- Use supplied thin set between all courses and all block.

TIP *Apply thin set to the inside of block to prevent excess from squeezing out onto the face of the mailbox.*

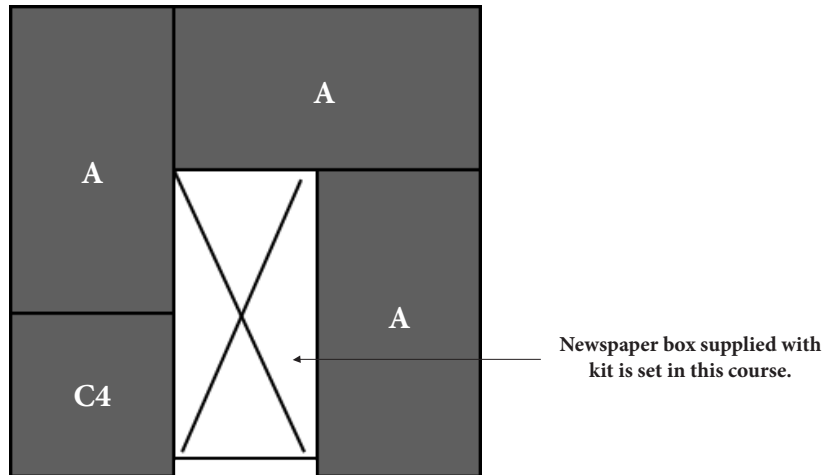

Course 10

- (3) Block “A” (4" x 8" x 16")
- (1) Block “C4” (4" x 8" x 8")

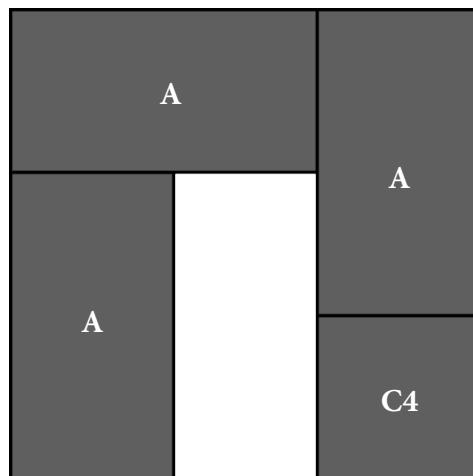

Course 11

- (3) Block “A” (4" x 8" x 16")
- (1) Block “C4” (4" x 8" x 8")

**Step
6**

Build the mailbox (courses 12 and 13).

- Use supplied thin set between all courses and all block.

 **TIP** Apply thin set to the inside of block to prevent excess from squeezing out onto the face of the mailbox.

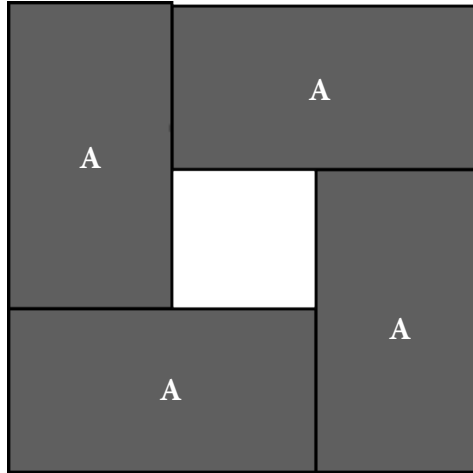

Course 12

(4) Block “A” (4" x 8" x 16")

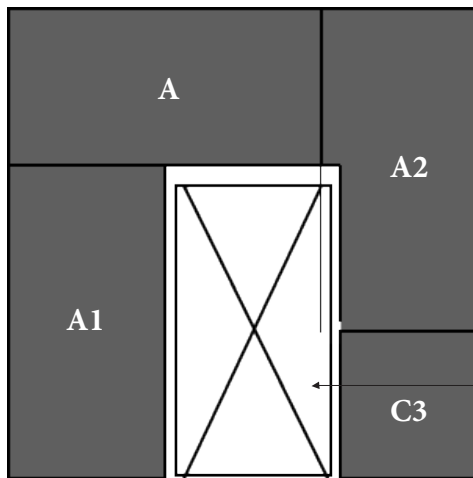

Course 13

- (1) Block “A” (4" x 8" x 16")
- (1) Block “A1” (4" x 6 1/2" x 16")
- (1) Block “A2” (4" x 8" x 16"; special cut)
- (1) Block “C3” (4" x 6 5/8" x 8")

Step
7

Build the mailbox (courses 14 and 15).

- Use supplied thin set between all courses and all block.

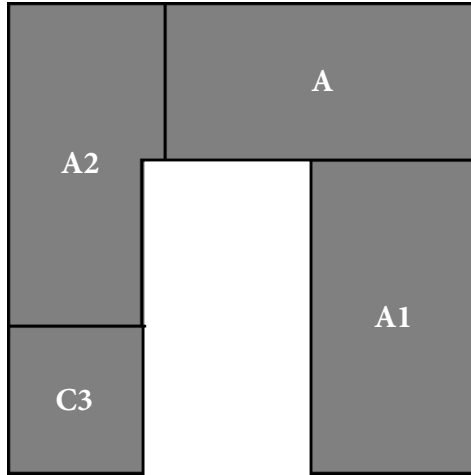

Course 14

- (1) Block “A” (4" x 8" x 16")
- (1) Block “A1” (4" x 6 1/2" x 16")
- (1) Block “A2” (4" x 8" x 16"; special cut)
- (1) Block “C3” (4" x 6 1/2" x 8")

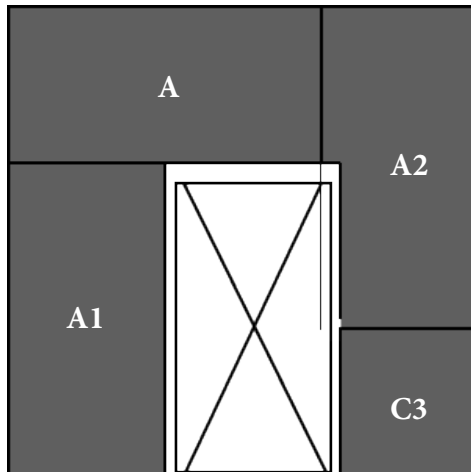

Course 15

- (1) Block “A” (4" x 8" x 16")
- (1) Block “A1” (4" x 6 1/2" x 16")
- (1) Block “A2” (4" x 8" x 16"; special cut)
- (1) Block “C3” (4" x 6 5/8" x 8")

**Step
8**

Build the mailbox (courses 16 and 17).

- Use supplied thin set between all courses and all block.

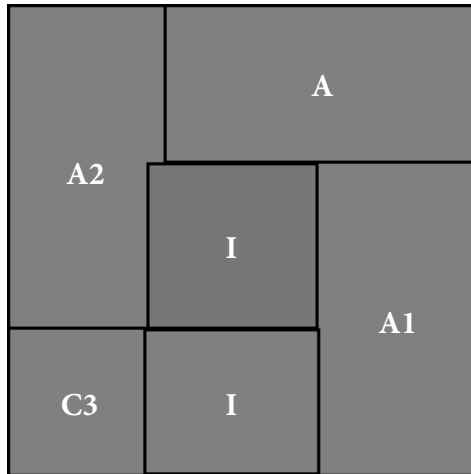

Course 16

- (1) Block “A” (4" x 8" x 16")
- (1) Block “A1” (4" x 6 1/2" x 16")
- (1) Block “A2” (4" x 8" x 16"; special cut)
- (1) Block “C3” (4" x 6 1/2" x 8")
- (2) Block “I” (2 1/4" x 8" x 10")

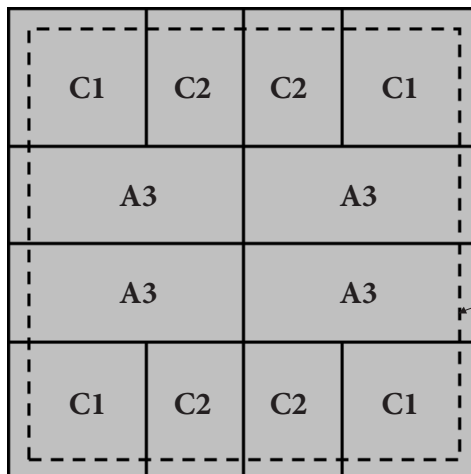

Course 17 (Cap)

- (4) Bullnose Block “A3” (4" x 5 1/2" x 16")
- (4) Corner Block “C1” (4" x 8" x 8")
- (4) Block “C2” (4" x 5 3/4" x 8")